

ANEXOS

ANEXO A

**PLANTAS ESTRUCTURALES
HOSPITAL REGIONAL DE TEMUCO**

CUERPO A

HOSPITAL DE TEMUCO

CUERPO A

PLANTA ESTRUCTURAL PISO I

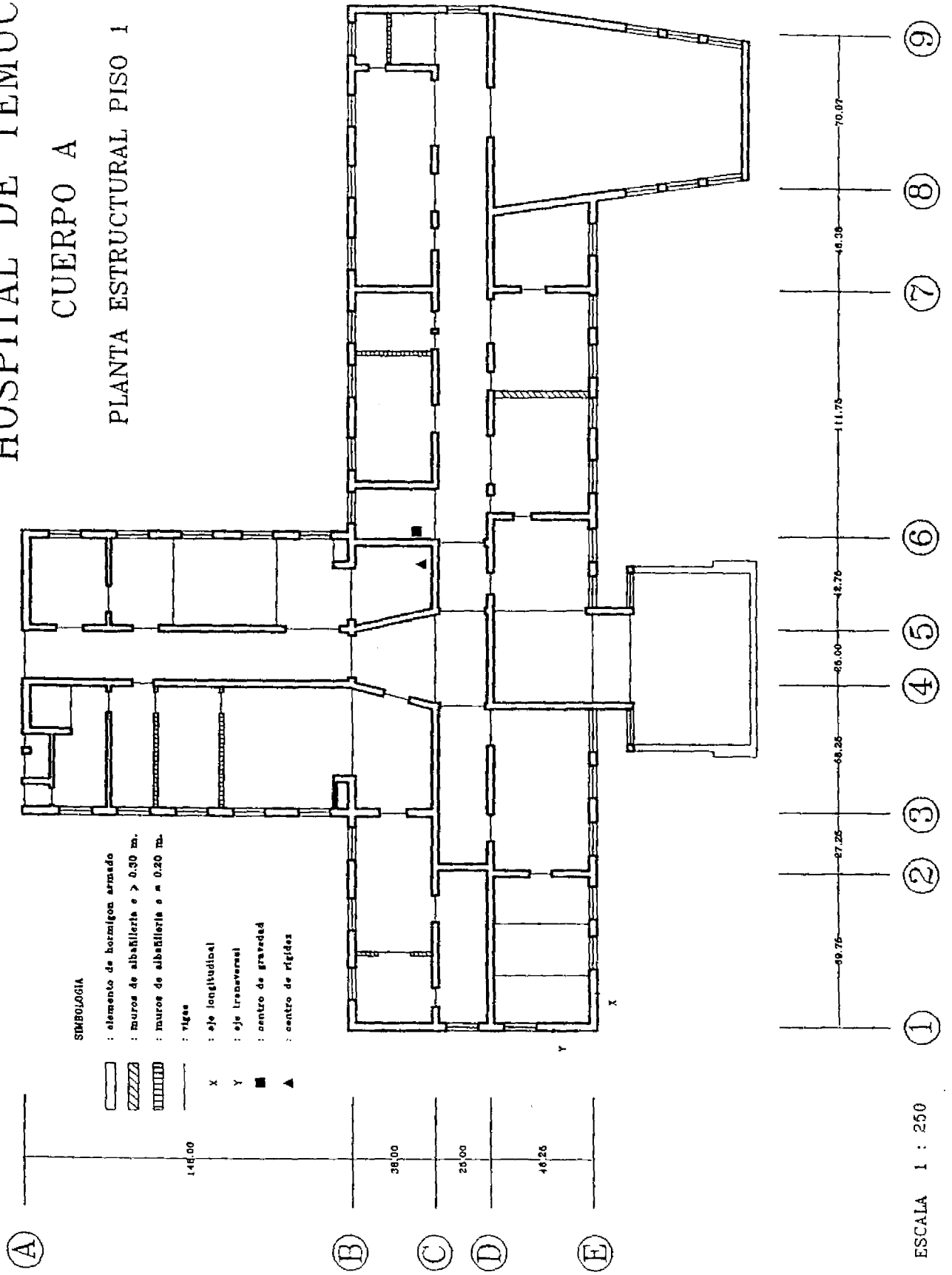

ESCALA 1 : 250

HOSPITAL DE TEMUCO

CUERPO A

PLANTA ESTRUCTURAL PISO 2

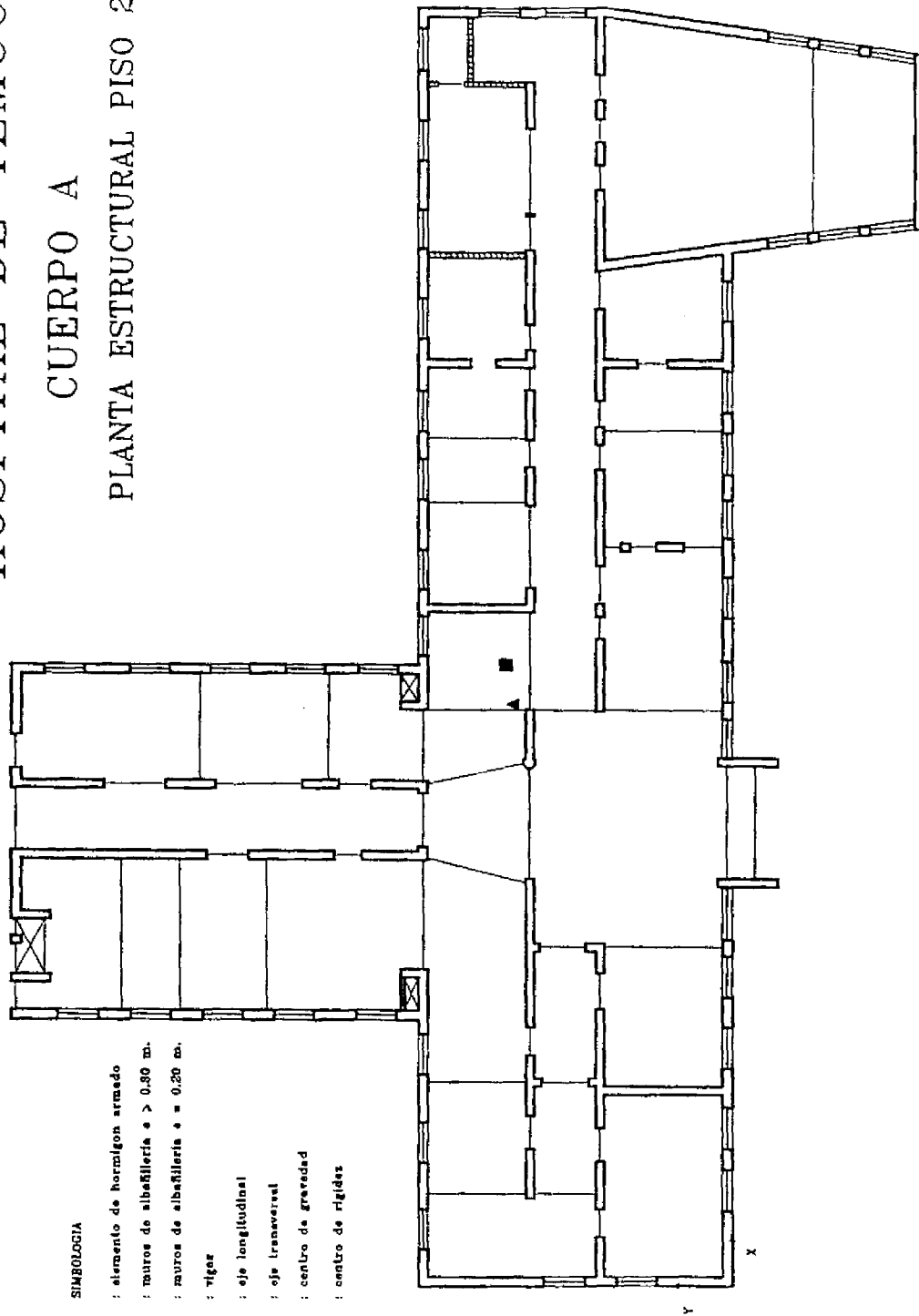

SIMBOLOGIA

- : elemento de hormigón armado
- : muros de albañilería $\epsilon > 0.80$ m.
- : muros de albañilería $\epsilon = 0.20$ m.
- : vigas
- X : eje longitudinal
- Y : eje transversal
- : centro de gravedad
- ▲ : centro de rigidez

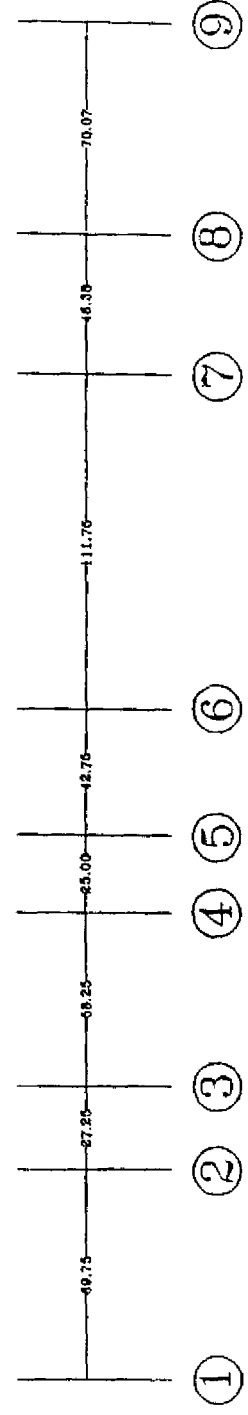
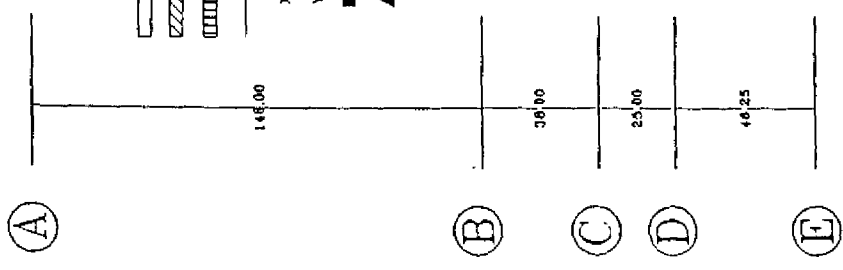

ESCALA 1 : 250

HOSPITAL DE TEMUCO

CUERPO A

PLANTA ESTRUCTURAL PISO 3

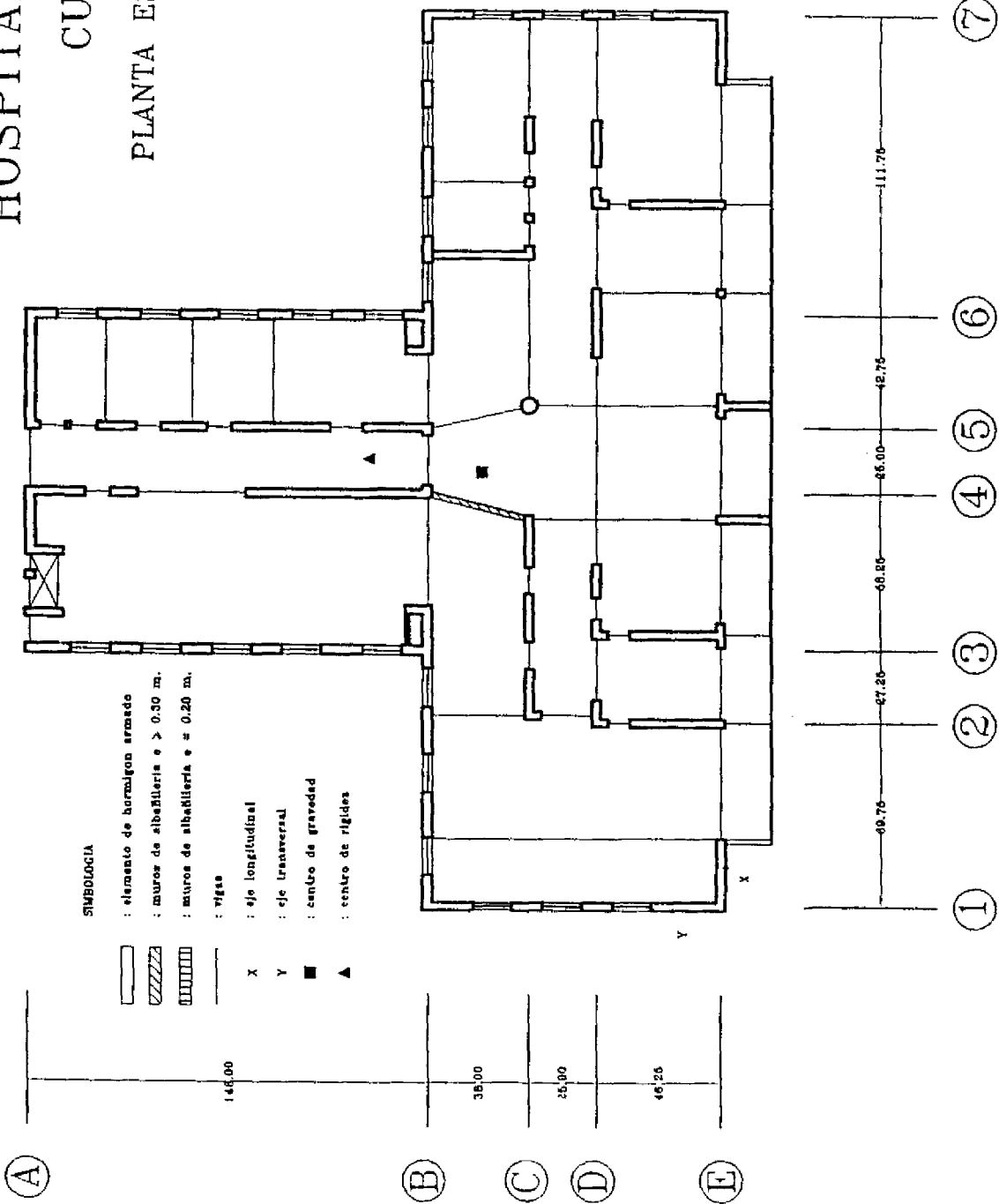

HOSPITAL DE TEMUCO

CUERPO A

PLANTA ESTRUCTURAL PISO 5

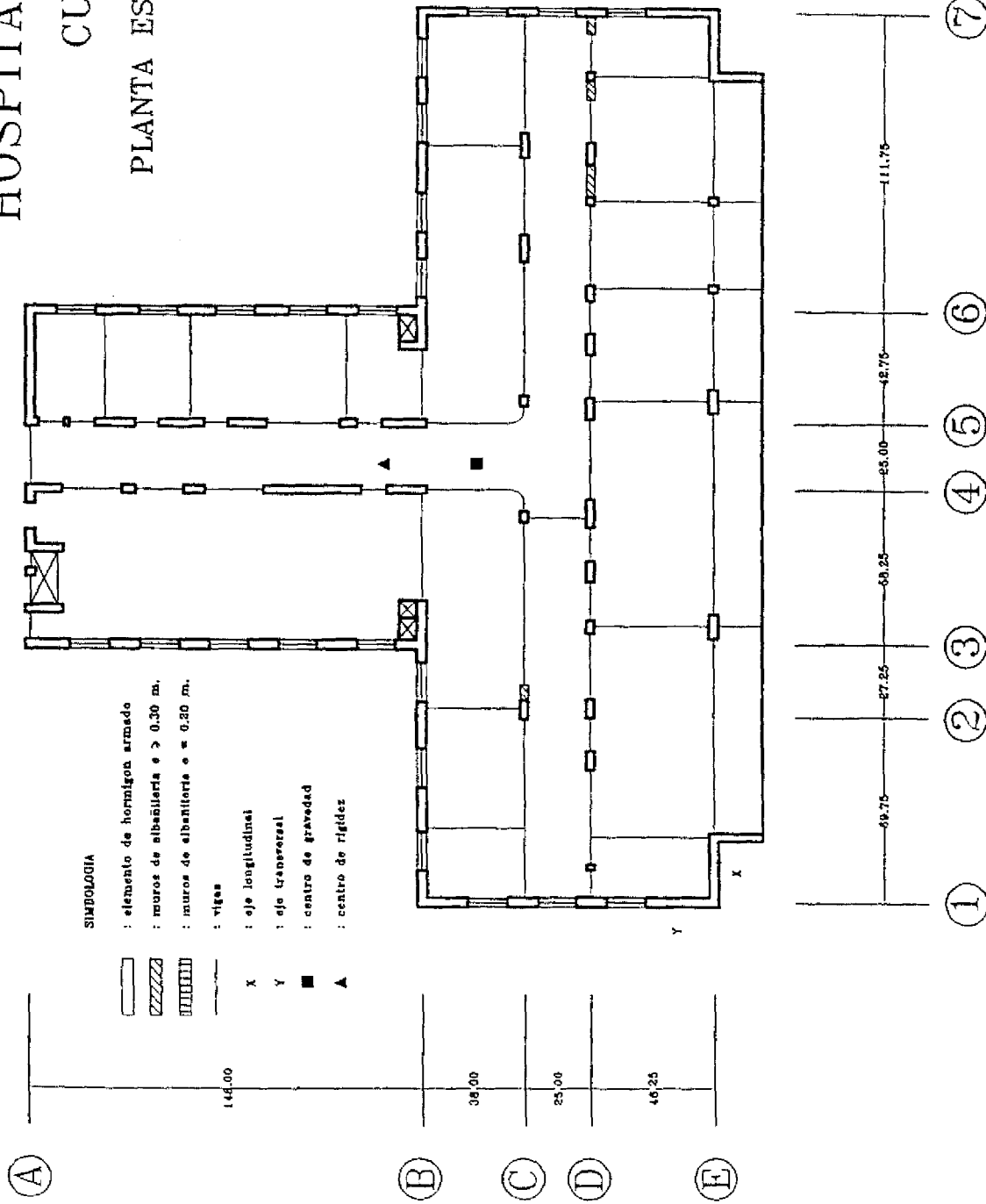

HOSPITAL DE TEMUCO

CUERPO A

PLANTA ESTRUCTURAL PISO 6

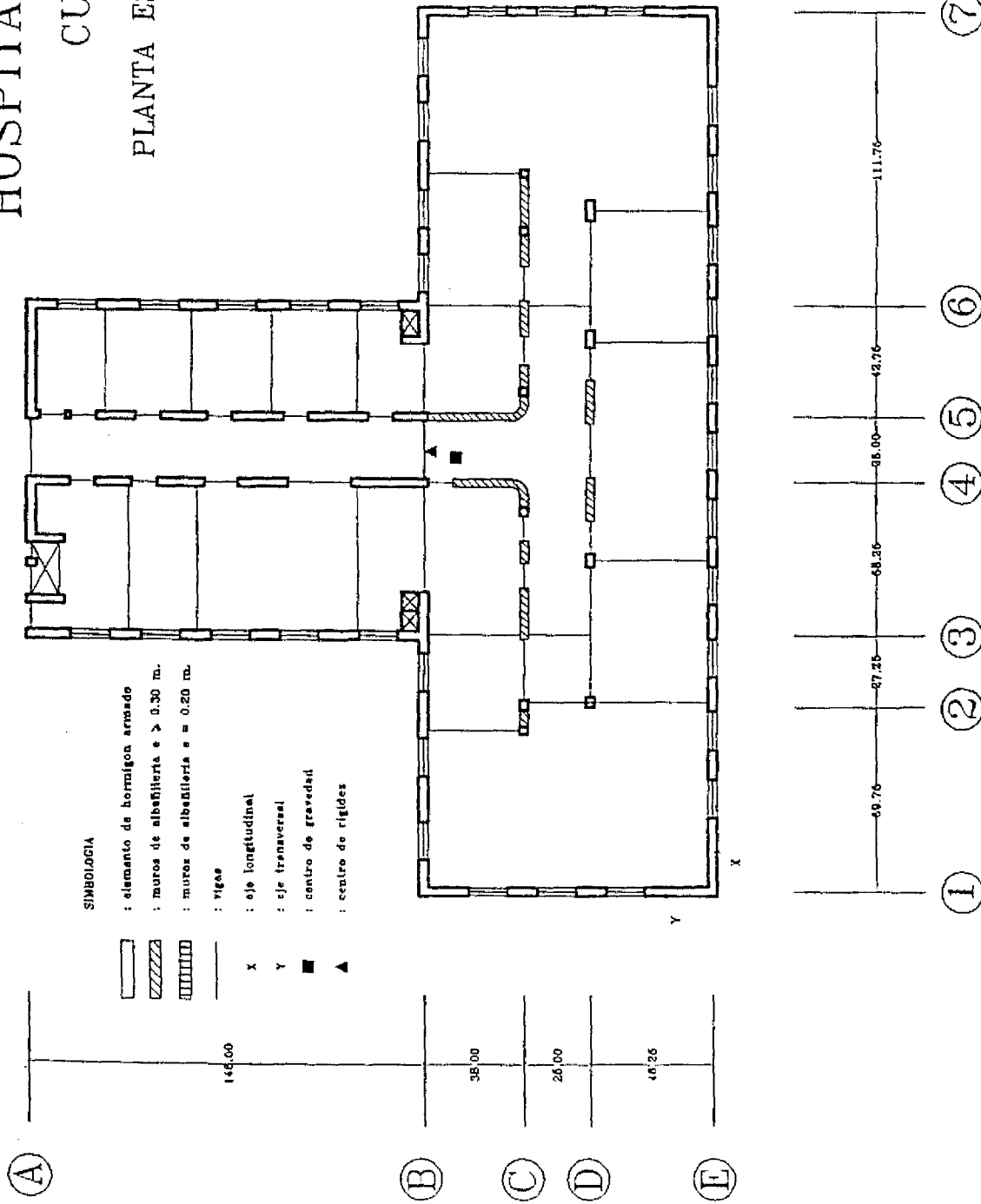

HOSPITAL DE TEMUCO

CUERPO A

PLANTA ESTRUCTURAL PISO 7

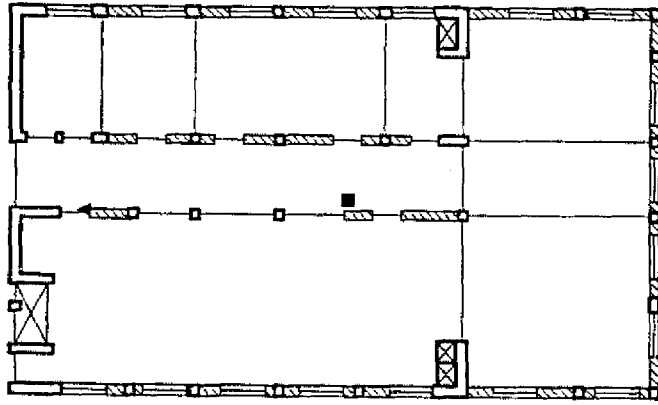

SIMBOLOGIA

- : elemento de hormigon armado
- : muros de albañileria $e > 0.30$ m.
- : muros de albañileria $e = 0.20$ m.
- : vigas
- X : eje longitudinal
- Y : eje transversal
- : centro de gravedad
- ▲ : centro de rigidez

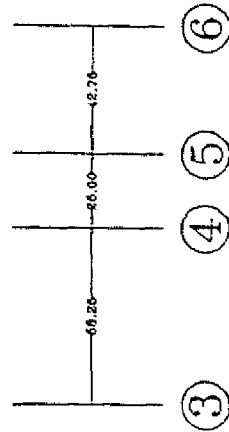
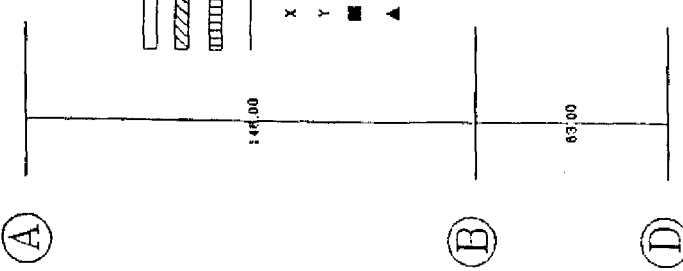







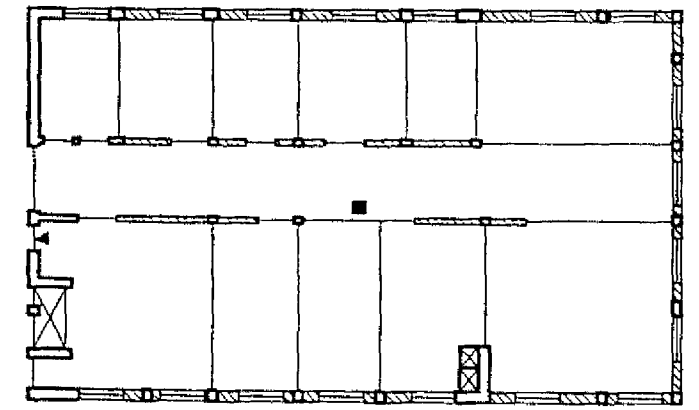

HOSPITAL DE TEMUCO

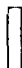
CUERPO A

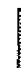
PLANTA ESTRUCTURAL PISO 8

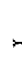

SIMBOLOGIA

-  : elemento de hormigón armado
-  : muros de albañilería $e > 0.30$ m.
-  : muros de albañilería $e = 0.20$ m.
-  : vigas
-  : eje longitudinal
-  : eje transversal
-  : centro de gravedad
-  : centro de rigidez

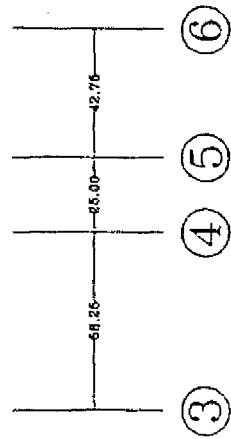
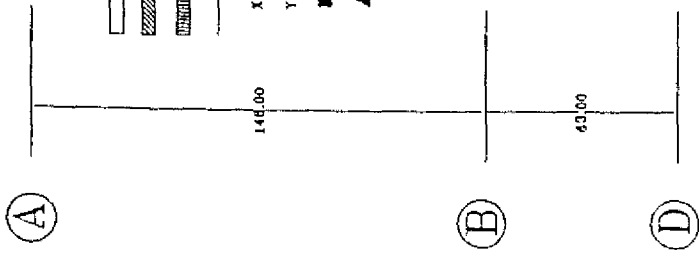







CUERPO B

HOSPITAL DE TEMUCO

CUERPO B

PLANTA ESTRUCTURAL PISO 1

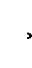
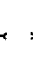
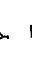
SIMBOLOGIA

-  : elemento de hormigón armado
-  : muros de albañilería $e > 0.30$ m.
-  : muros de albañilería $e = 0.20$ m.
-  : vigas
-  X : eje longitudinal
-  Y : eje transversal
-  : centro de gravedad
-  : centro de rigidez

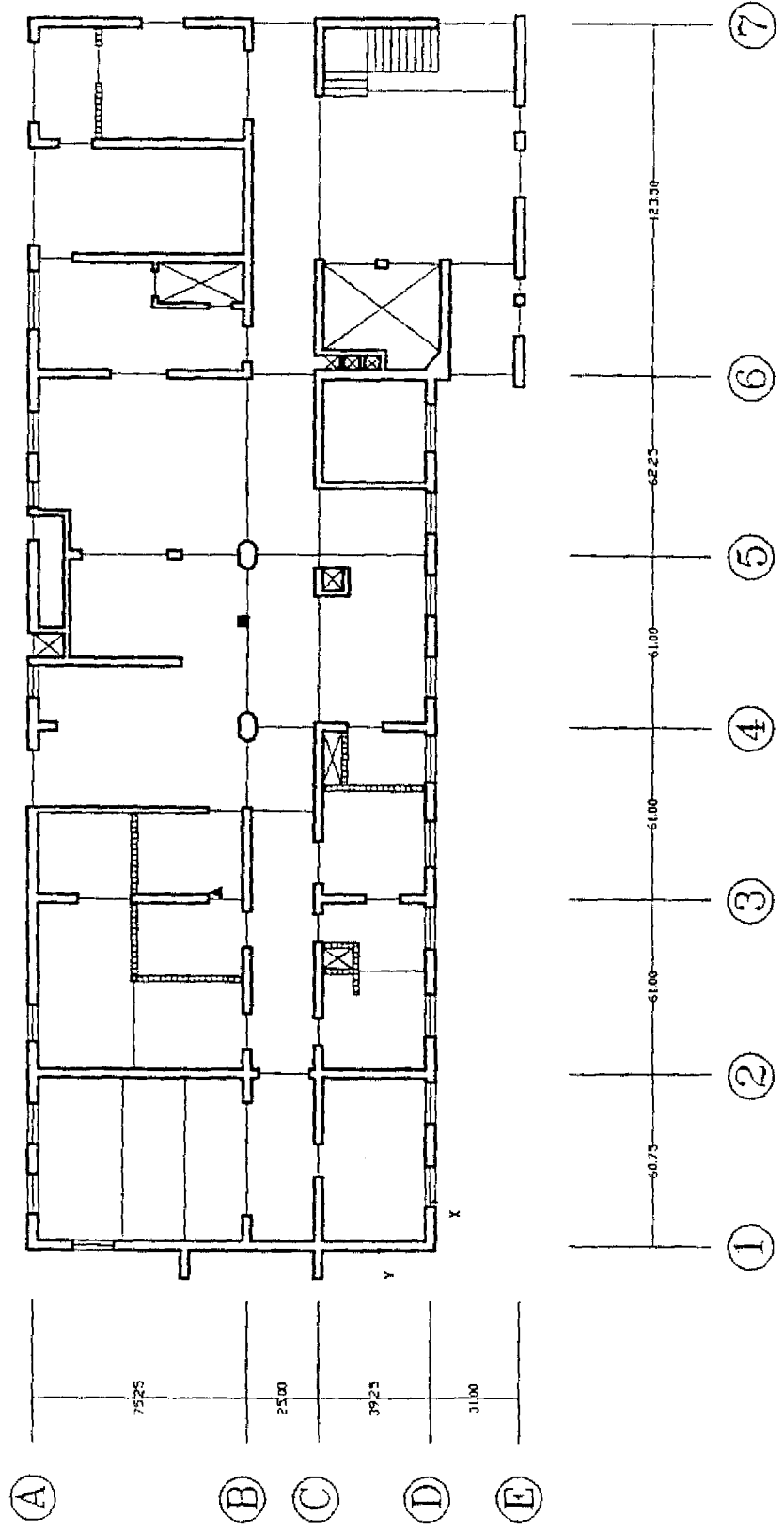





HOSPITAL DE TEMUCO

CUERPO B

PLANTA ESTRUCTURAL PISO 2

SIMBOLOGIA

-  : elemento de hormigón armado
-  : muros de albañilería $\phi > 0.30$ m.
-  : muros de albañilería $\phi \leq 0.20$ m.
-  : vigas



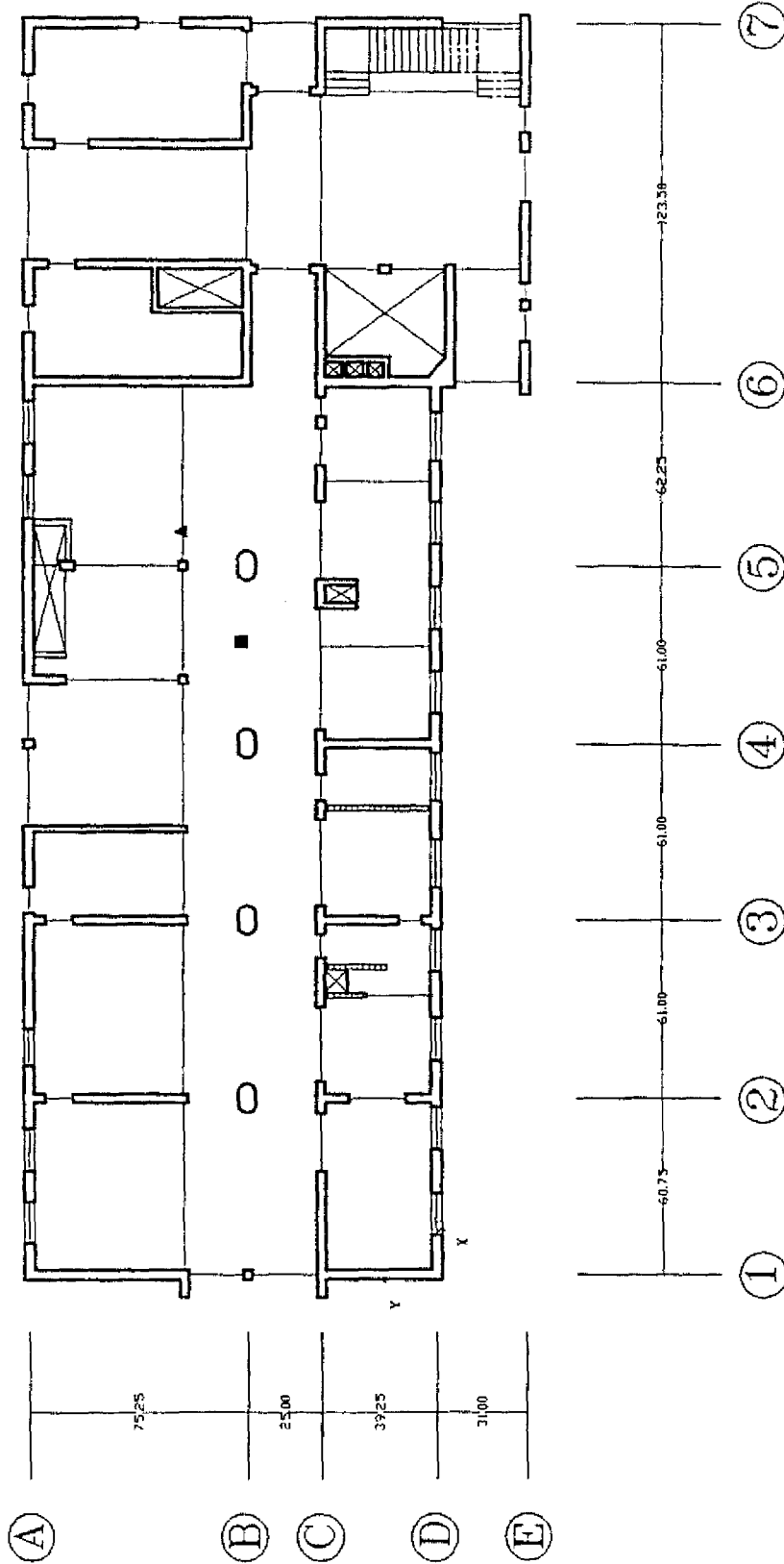



- X : eje longitudinal
- Y : eje transversal
- : centro de gravedad
- A : centro de rigidez



HOSPITAL DE TEMUCO

CUERPO B

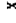
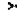
PLANTA ESTRUCTURAL PISO 3

- SIMBOLOGIA**
-  : elemento de hormigón armado
 -  : muros de albañilería > 0.30 m.
 -  : muros de albañilería = 0.20 m.
 -  : viga
 -  X : eje longitudinal
 -  Y : eje transversal
 -  ■ : centro de gravedad
 -  : centro de rigidez

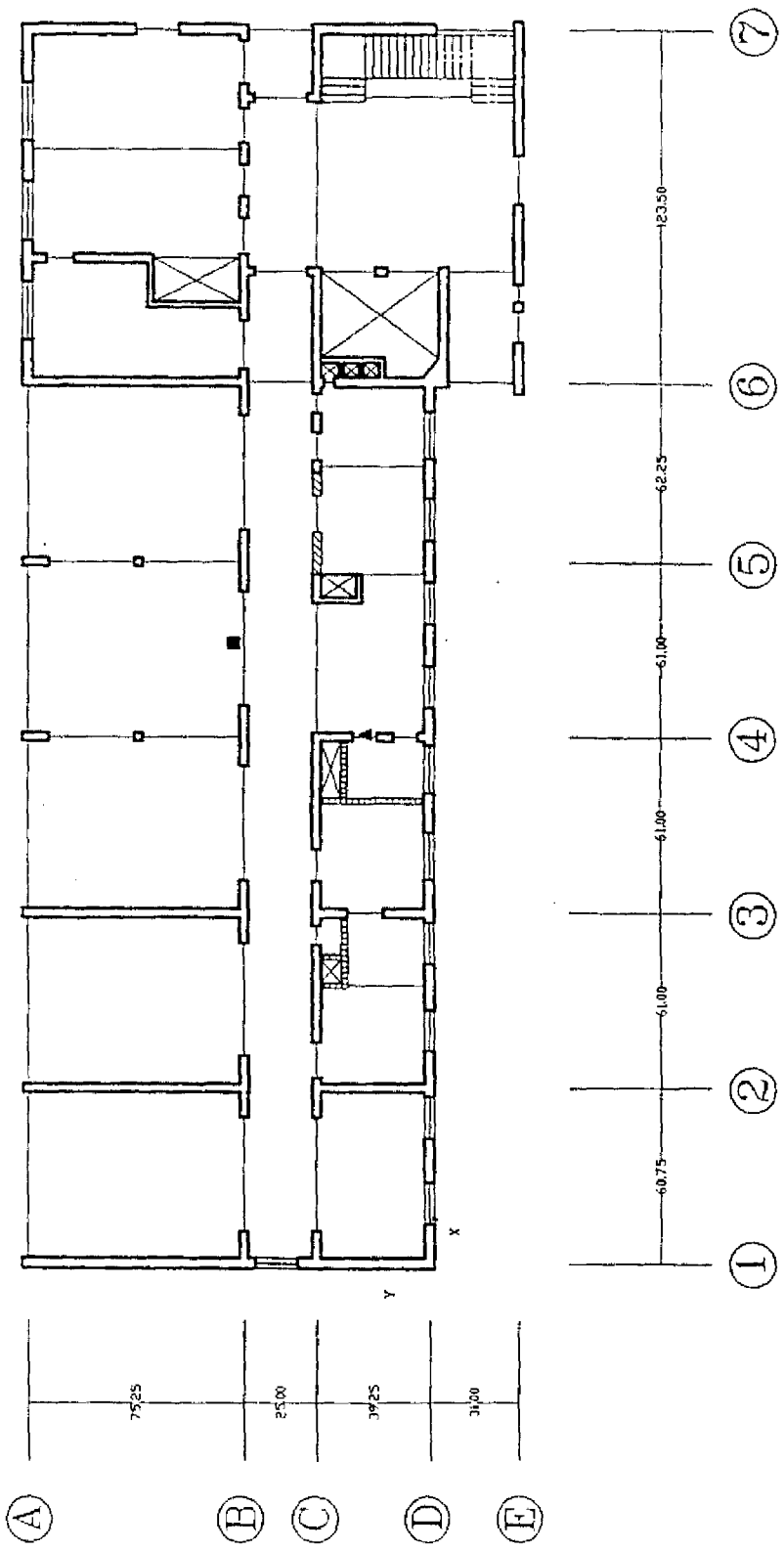





HOSPITAL DE TEMUCO

CUERPO B

PLANTA ESTRUCTURAL PISO 4 Y 5

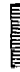
SIMBOLOGIA

-  : elemento de hormigon armado
-  : muros de albañileria e > 0.30 m.
-  : muros de albañileria e = 0.20 m.
-  : Vigas

- X : eje longitudinal
- Y : eje transversal
- : centro de gravedad
- ▲ : centro de rigidez

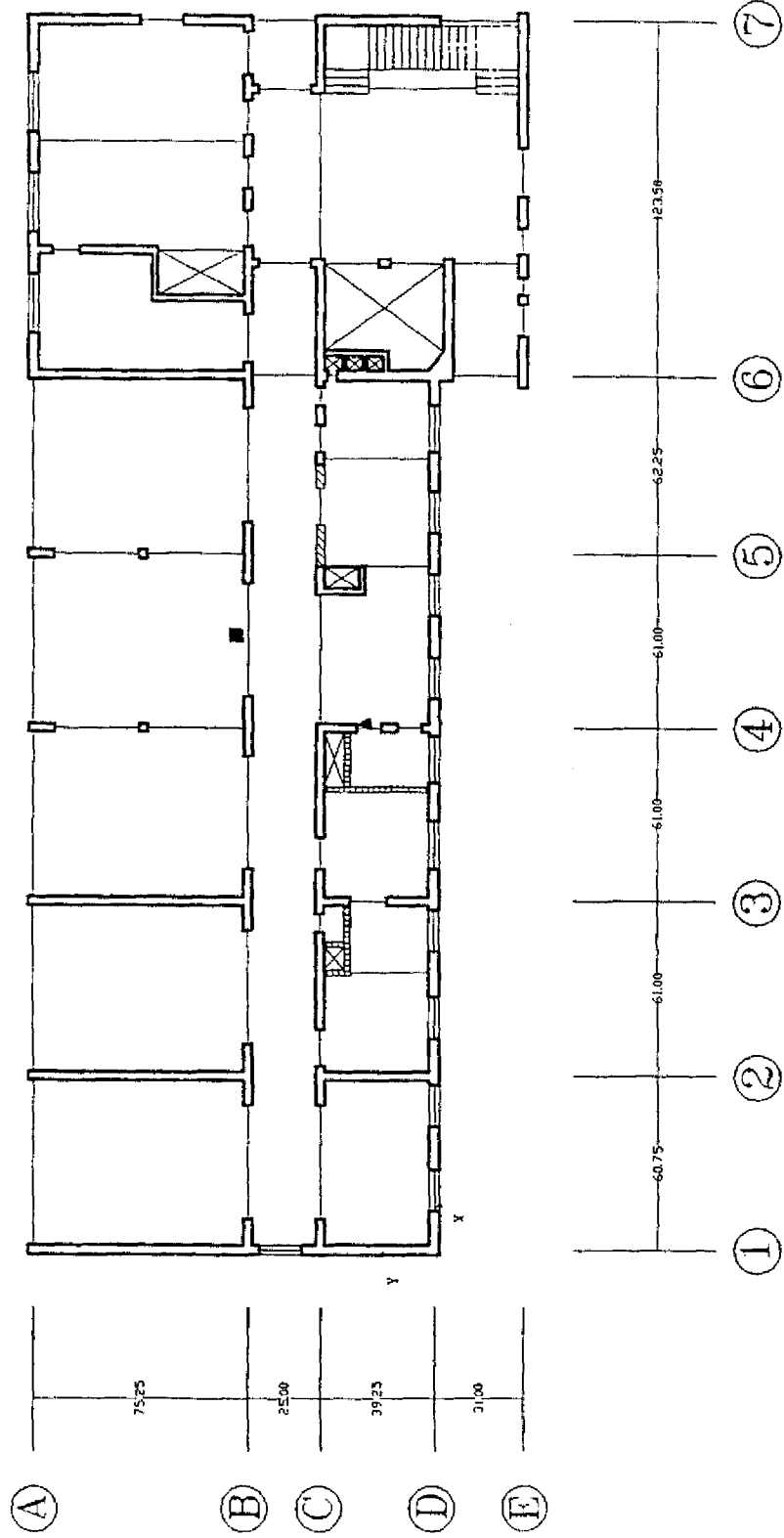







ESCALA 1 : 250

HOSPITAL DE TEMUCO

CUERPO B

PLANTA ESTRUCTURAL PISO 6

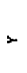
SIMBOLOGIA

-  : elemento de hormigón armado
-  : muros de albanilería e > 0.30 m.
-  : muros de albanilería e = 0.30 m.
-  : vigas
-  X : eje longitudinal
-  Y : eje transversal
-  ■ : centro de gravedad
-  ▲ : centro de rigidez

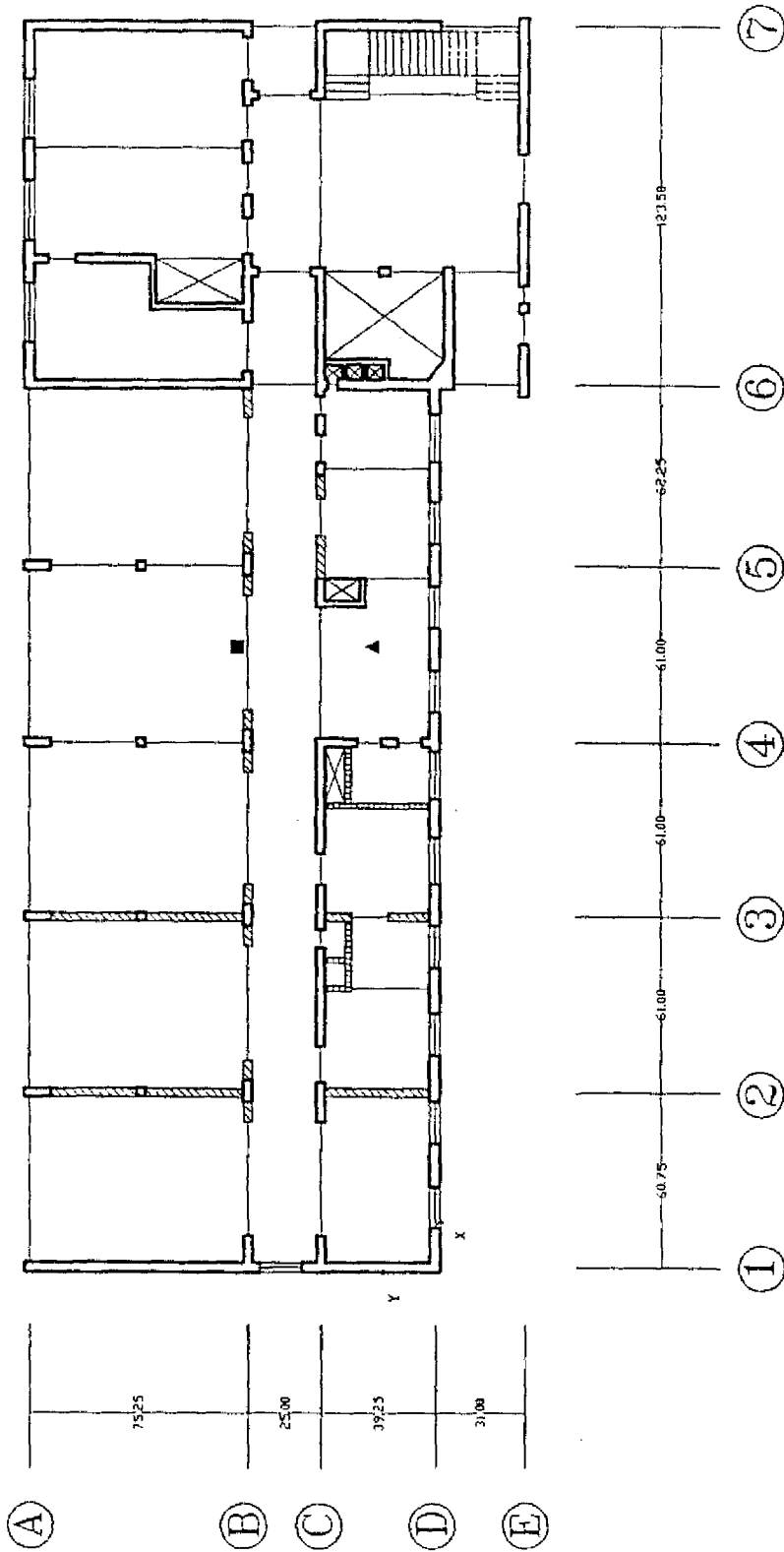





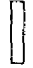

HOSPITAL DE TEMUCO

CUERPO B

PLANTA ESTRUCTURAL PISO 7

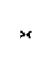
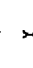
SIMBOLOGIA

-  : elemento de hormigón armado
-  : muros de albanilería e > 0.30 m.
-  : muros de albanilería e = 0.20 m.
-  : vigas
-  X : eje longitudinal
-  Y : eje transversal
-  ■ : centro de gravedad
-  ▲ : centro de rigidez

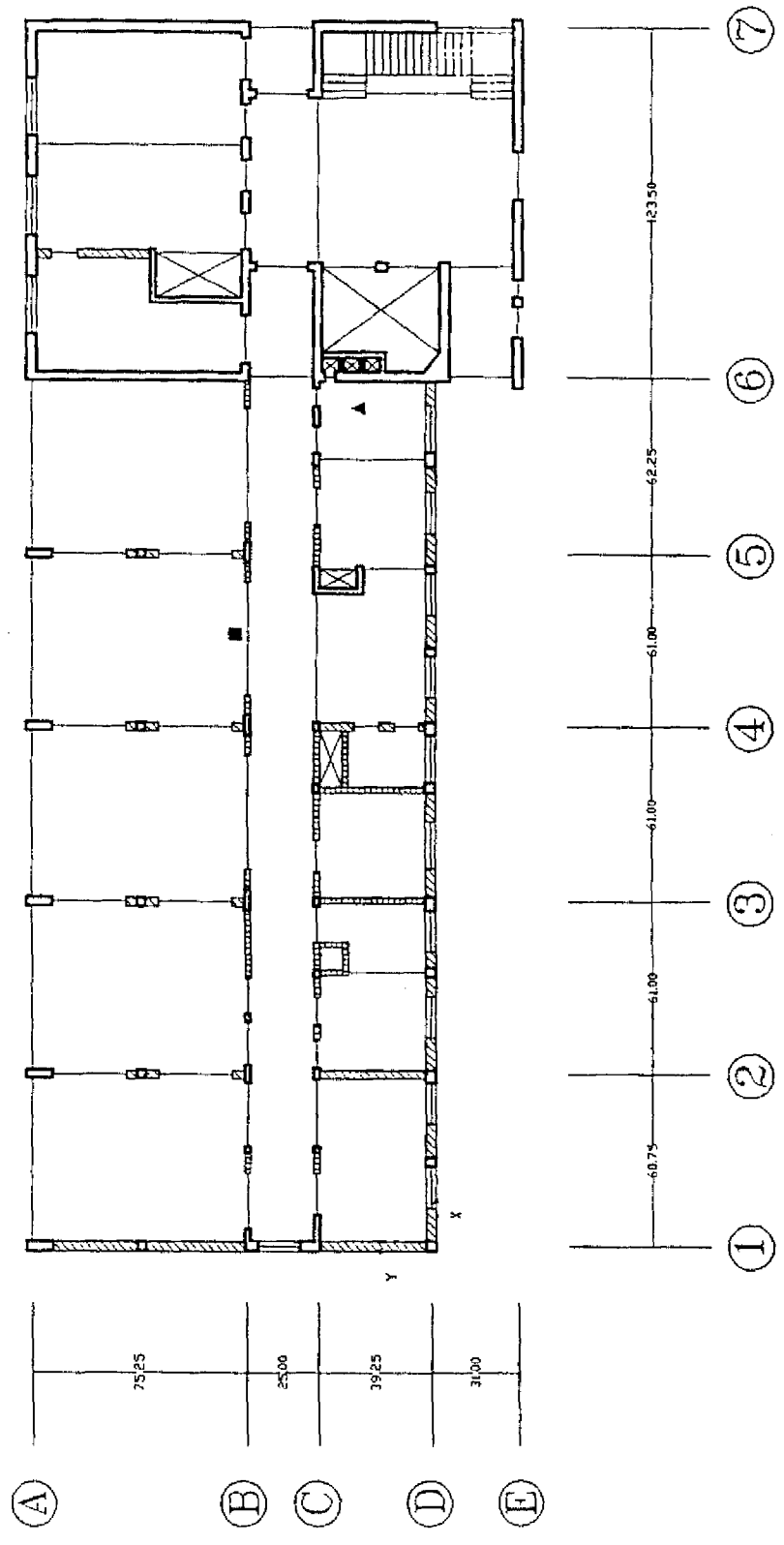







ESCALA 1 : 250

HOSPITAL DE TEMUCO

CUERPO B

PLANTA ESTRUCTURAL PISO 8

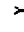
SIMBOLOGIA

-  : elemento de hormigón armado
-  : muros de albañilería e > 0.30 m.
-  : muros de albañilería e = 0.20 m.
-  : vigas
-  X : eje longitudinal
-  Y : eje transversal
-  ■ : centro de gravedad
-  ▲ : centro de rigidez

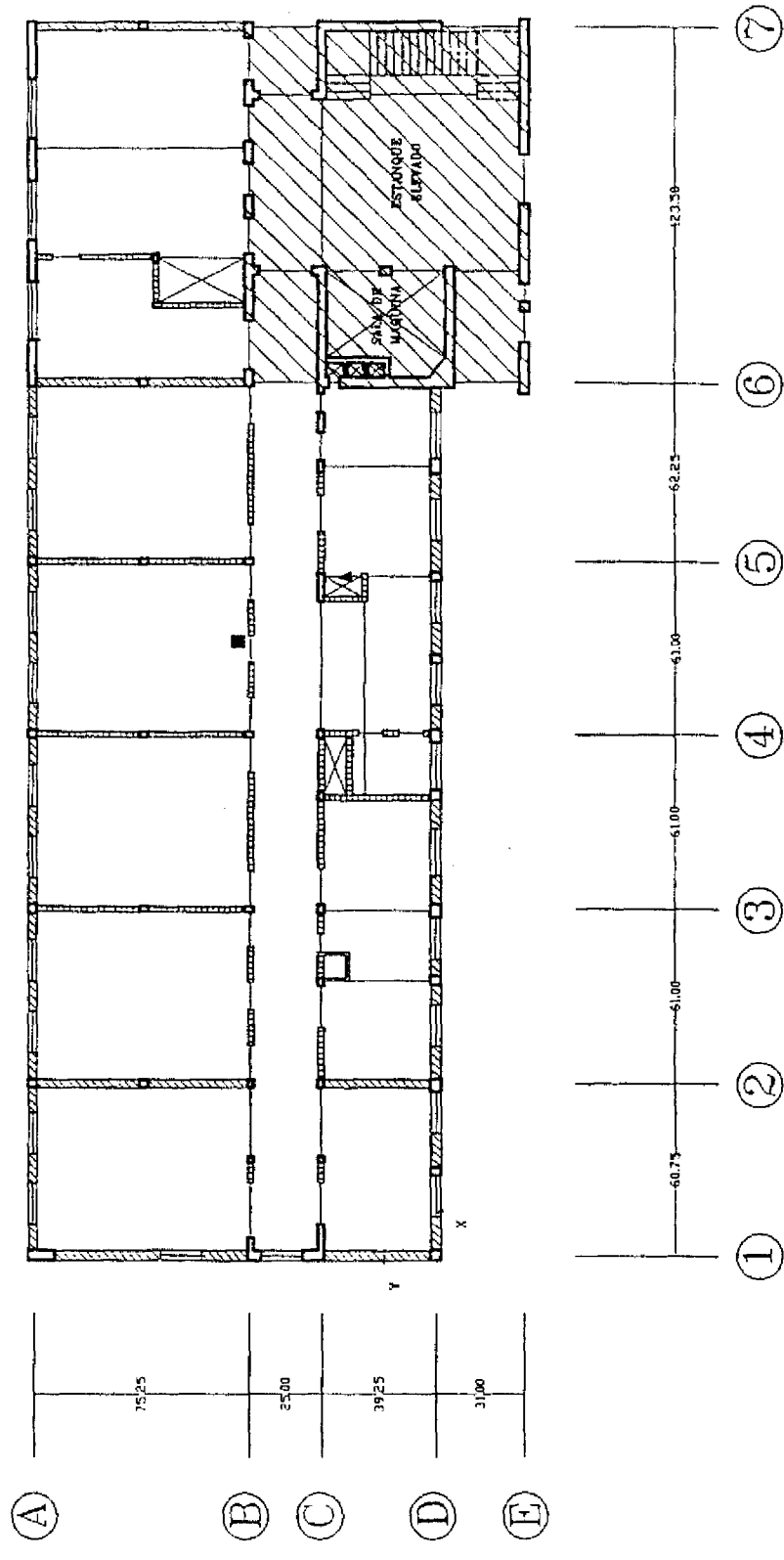

ESCALA 1 : 250

CUERPO B

PLANTA DEL FONDO DEL ESTANQUE ELEVADO

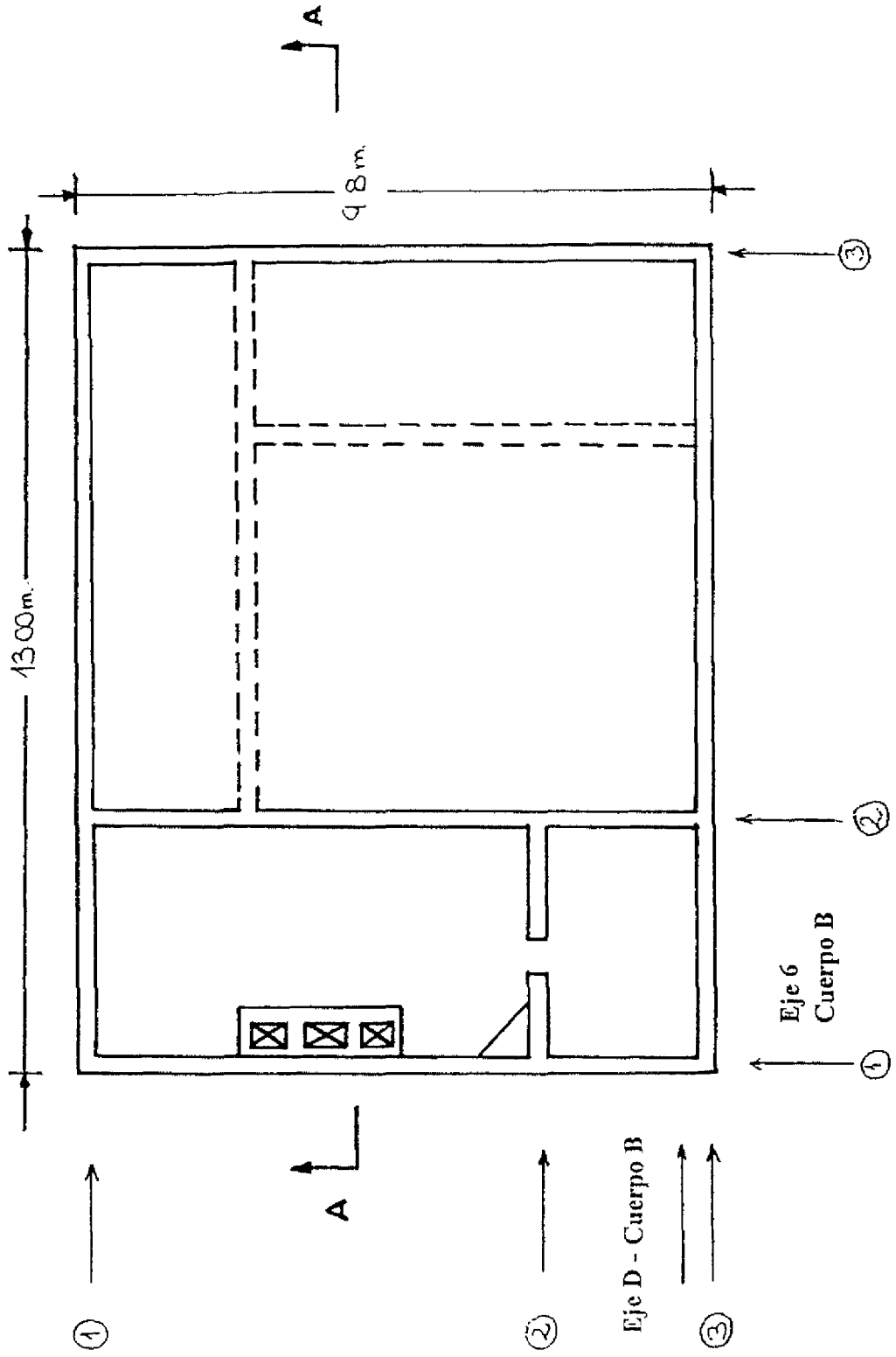

ESTANQUE ELEVADO - CUERPO B

CORTE A-A

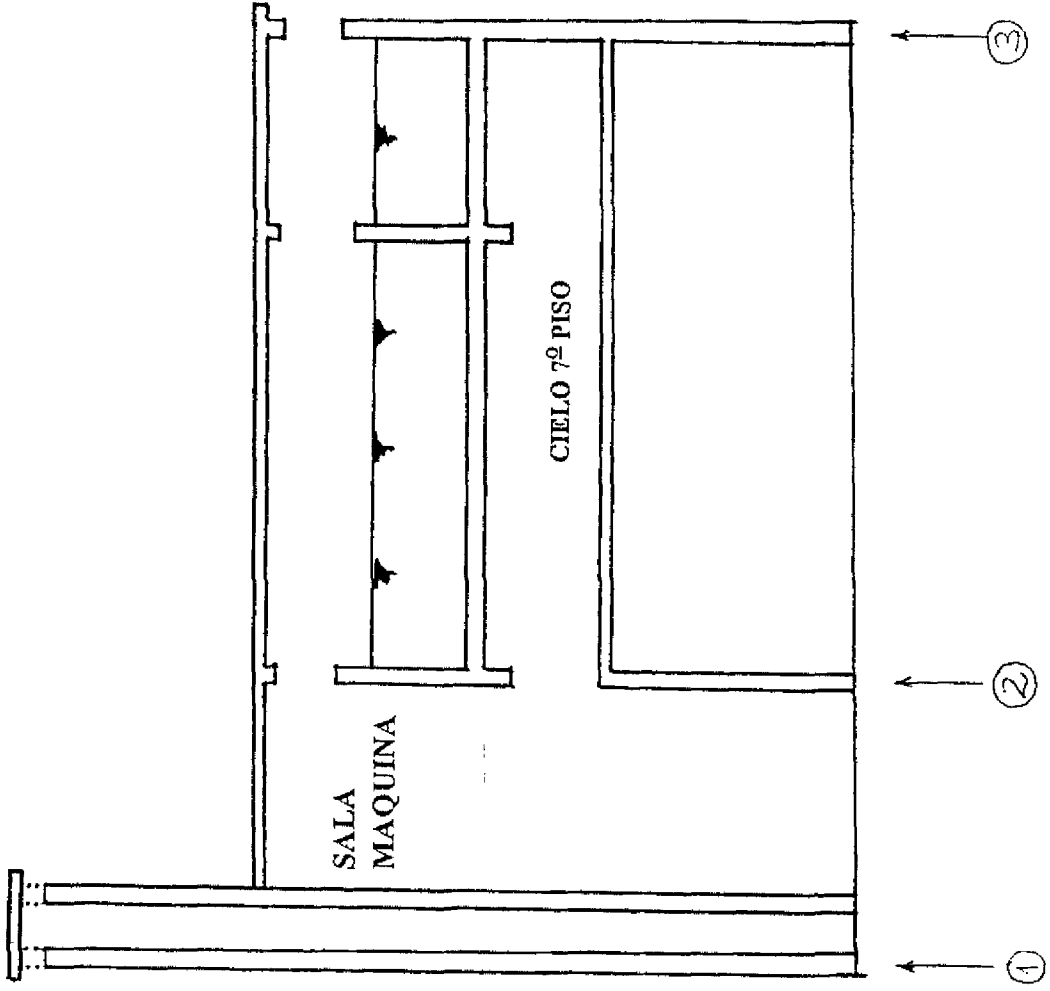









CUERPO D1

HOSPITAL DE TEMUCO

CUERPO D1 PLANTA ESTRUCTURAL PISO 1

SIMBOLOGIA

-  : elemento de hormigón armado
-  : muros de albañilería e > 0.80 m.
-  : muros de albañilería e < 0.20 m.
-  : vigas
-  X : eje longitudinal
-  Y : eje transversal
-  ■ : centro de gravedad
-  ▲ : centro de rigidez

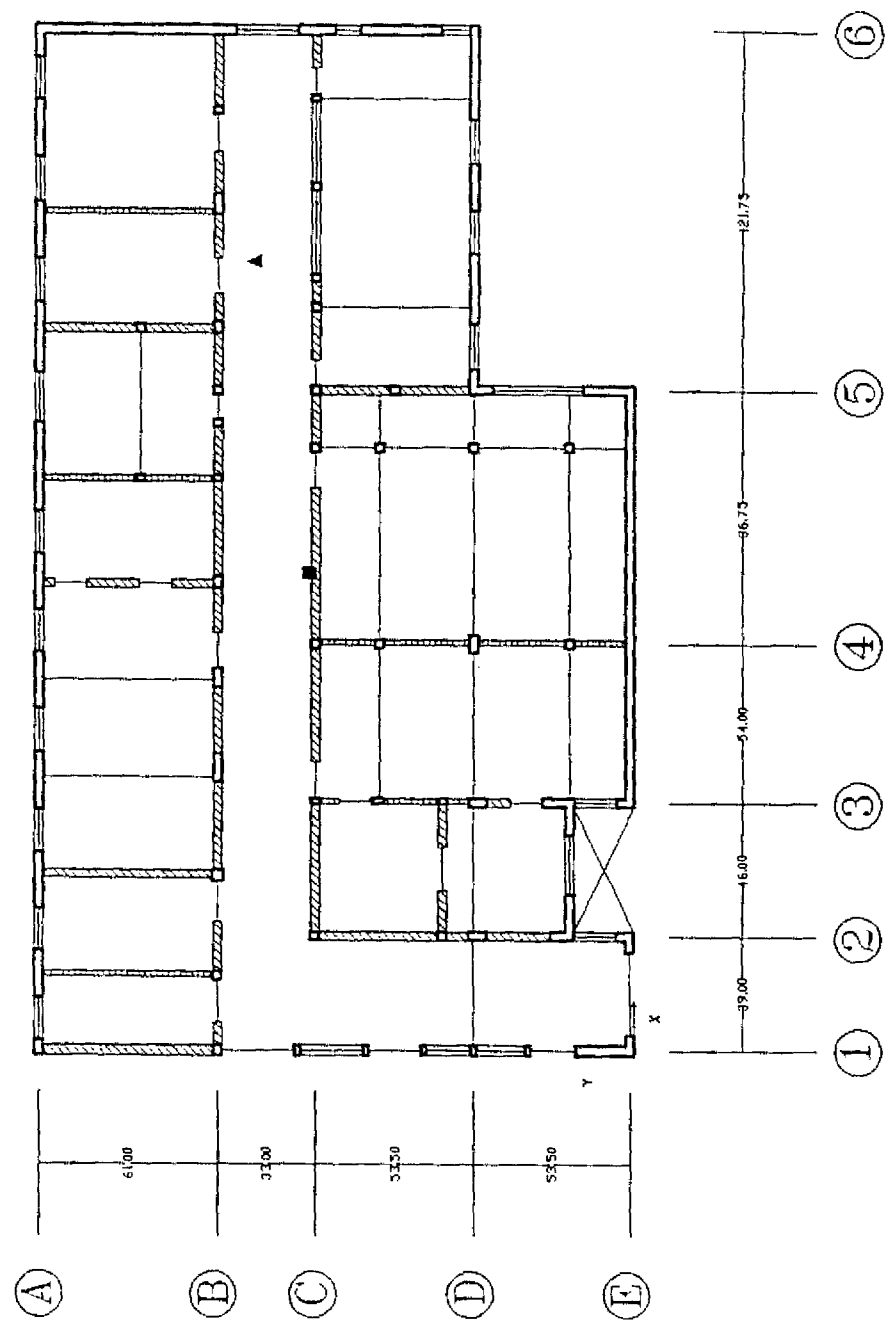













ESCALA 1 : 250

HOSPITAL DE TEMUCO

CUERPO D1

PLANTA ESTRUCTURAL PISO 2

SIMBOLOGIA

-  elemento de hormigón armado
-  muros de albañilería $e > 0.30$ m.
-  muros de albañilería $e = 0.20$ m.
-  vigas
-  eje longitudinal
-  eje transversal
-  centro de gravedad
-  cambio de rigidez
-  X
-  Y
-  ■
-  ▲

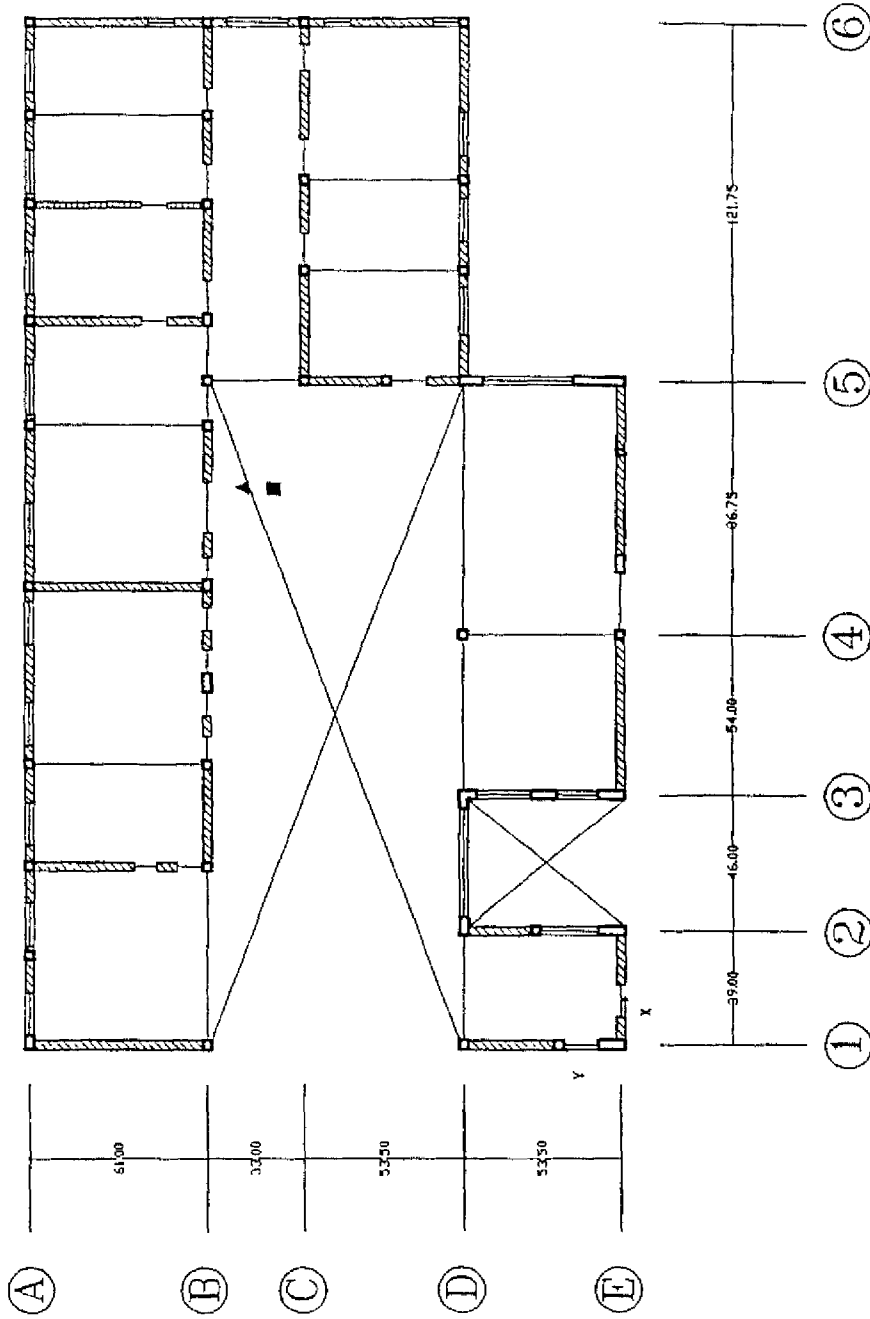

ESCALA 1 : 250







CUERPO D2

HOSPITAL DE TEMUCO

CUERPO D2

PLANTA ESTRUCTURAL PISO 1

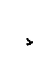
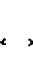
SIMBOLOGIA

-  : elemento de hormigón armado
-  : muros de albañilería > 0.30 m.
-  : muros de albañilería = 0.20 m.
-  : rígido
-  X : eje longitudinal
-  Y : eje transversal
-  ■ : centro de gravedad
-  ▲ : centro de rigidez

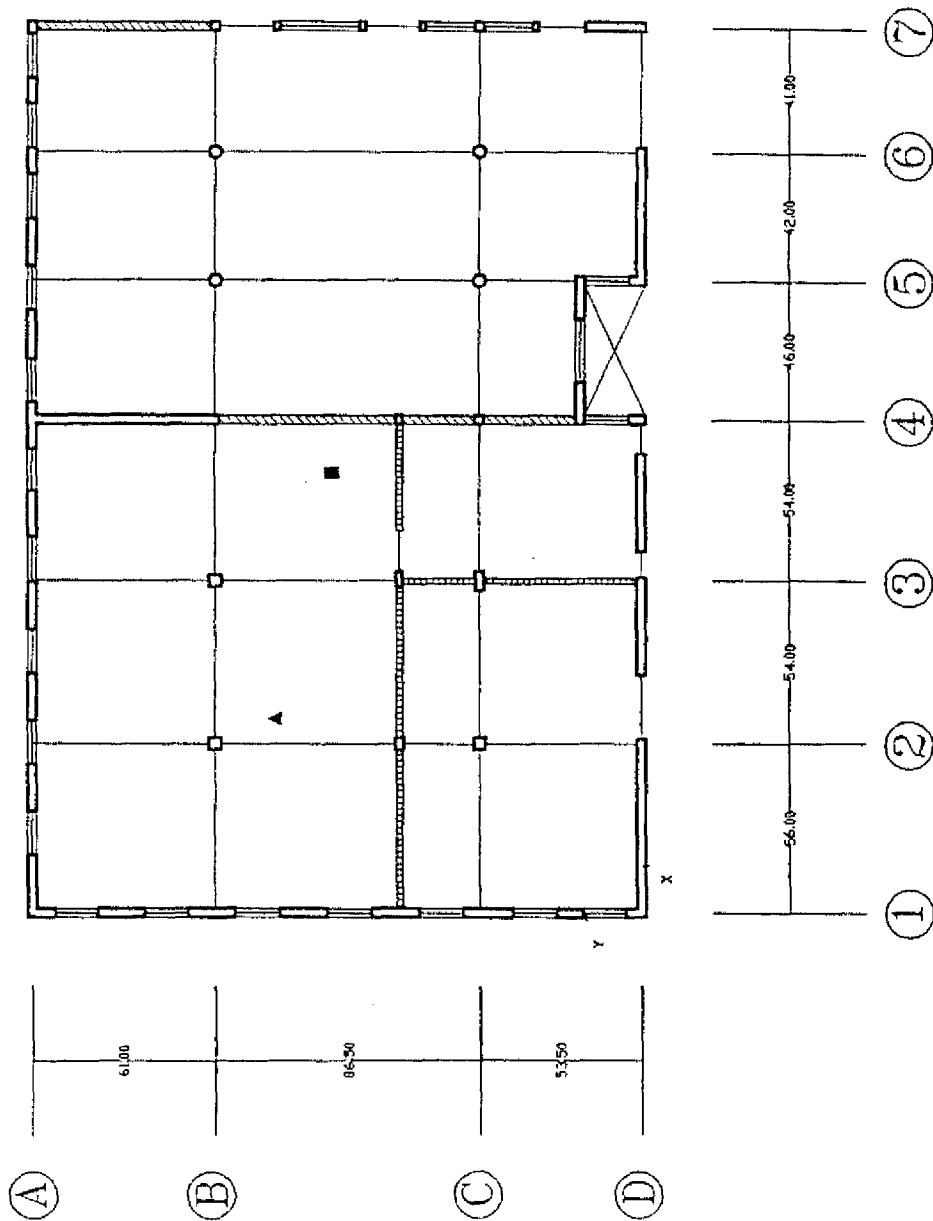









ESCALA 1 : 250

HOSPITAL DE TEMUCO

CUERPO D2

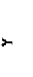
PLANTA ESTRUCTURAL PISO 2

-  : elemento de hormigón armado
-  : muros de albañilería e > 0.30 m.
-  : muros de albañilería e = 0.20 m.
-  : Vigas
-  X : eje longitudinal
-  Y : eje transversal
-  ■ : centro de gravedad
-  ▲ : centro de rigidez

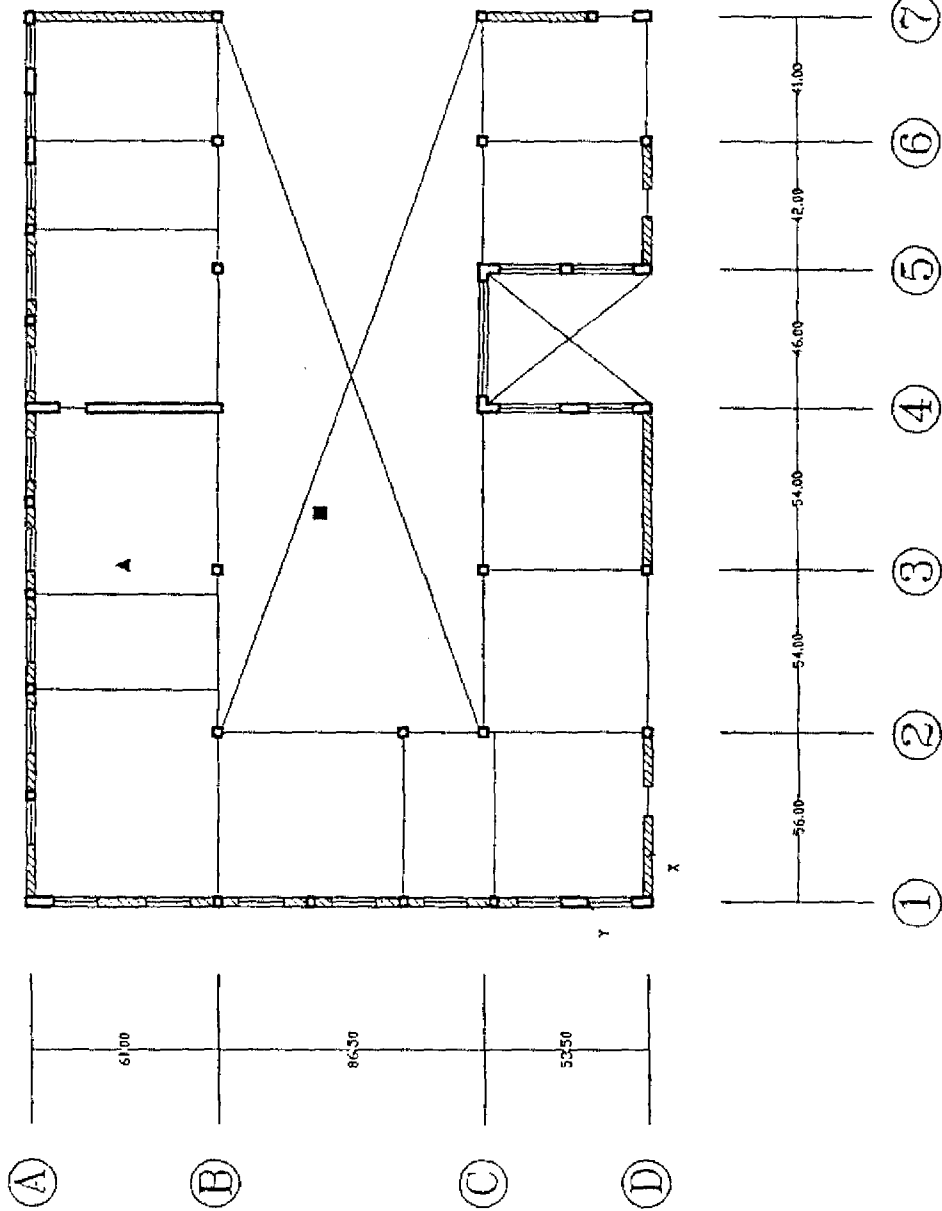

ESCALA 1 : 250

ANEXO B

**ELEVACIONES DE EJES
HOSPITAL REGIONAL DE TEMUCO**

CUERPO A

CUERPO A
Elevación eje A

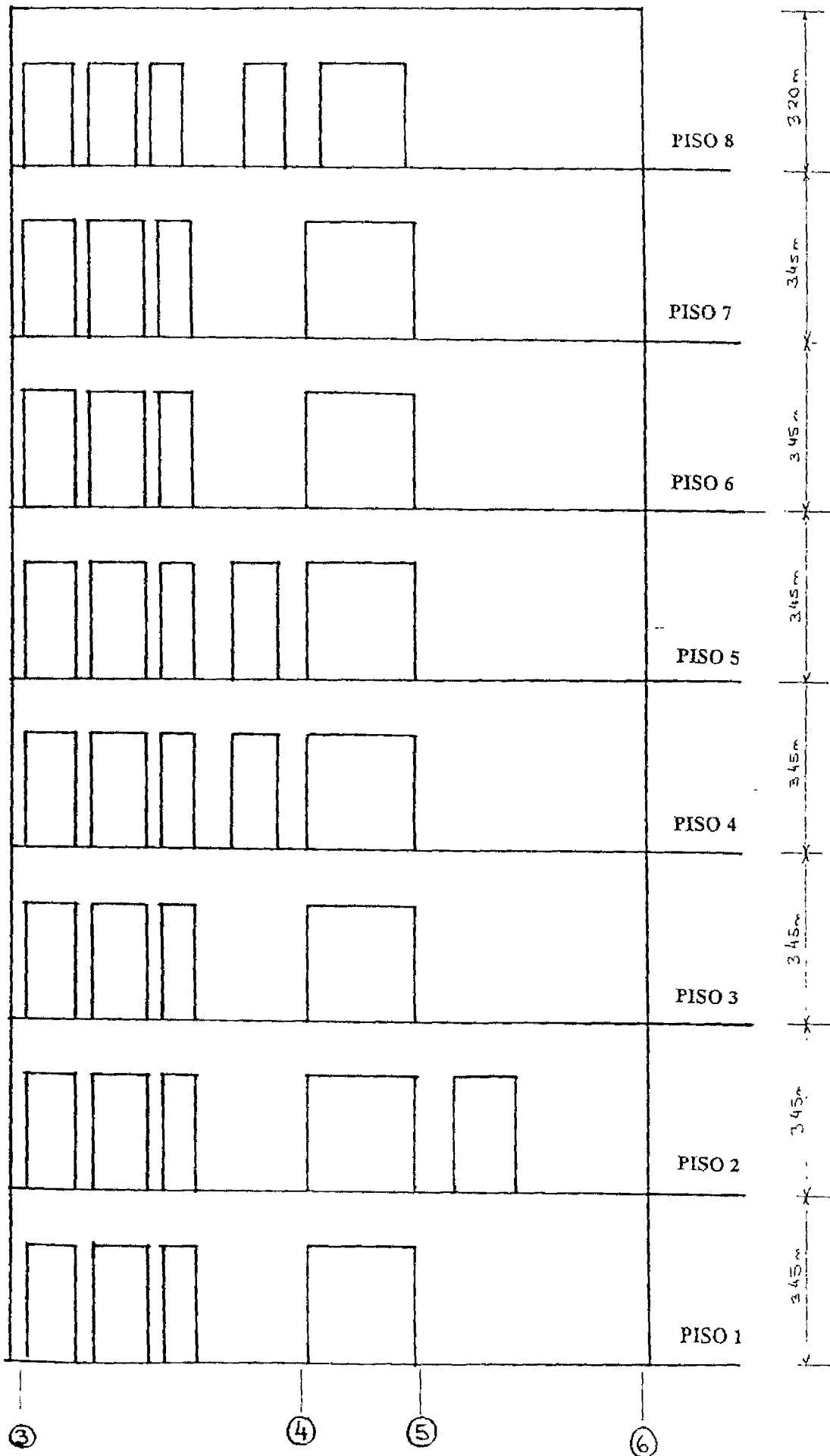

CUERPO A

Elevación eje B

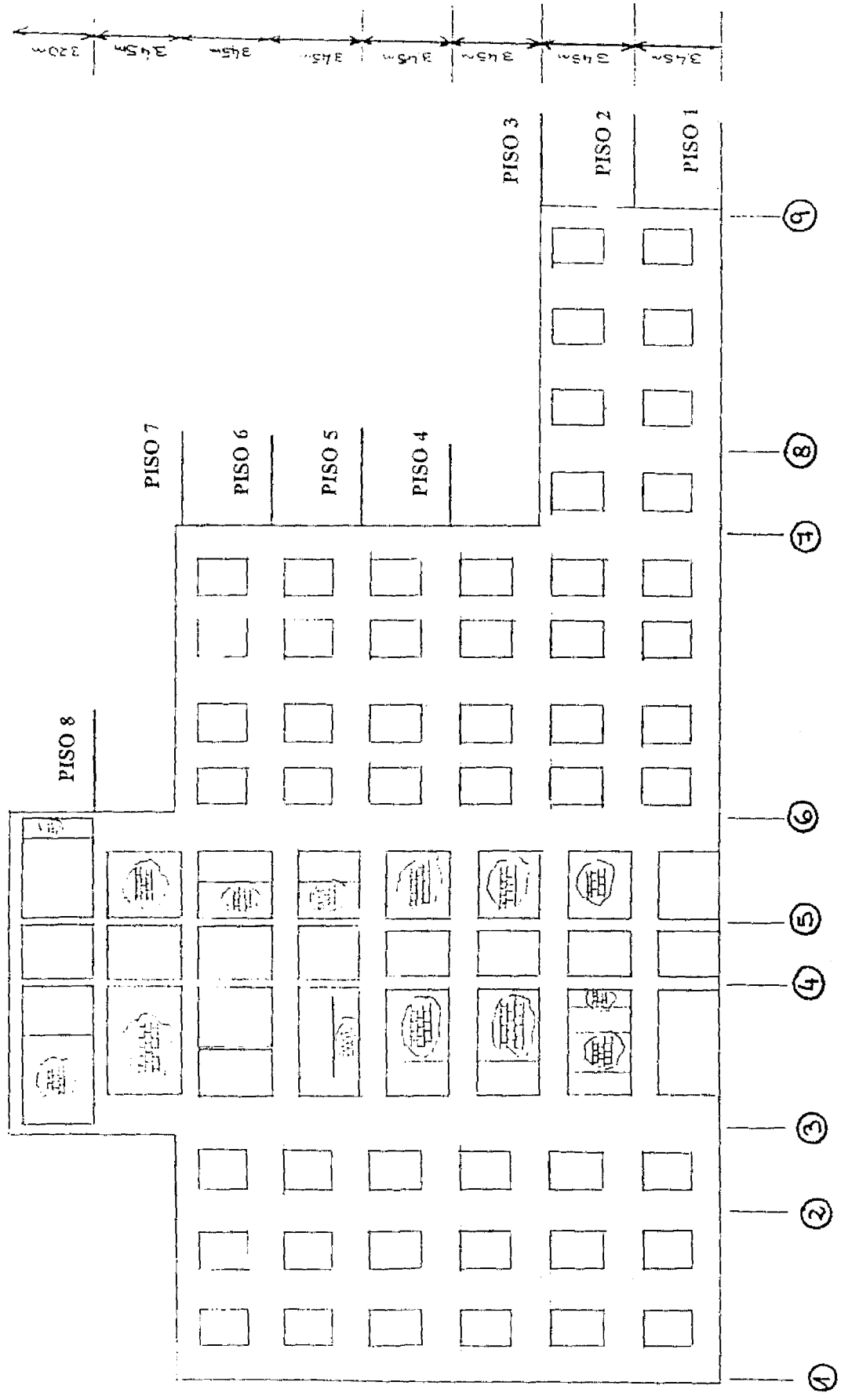

HOSPITAL DE TEMUCO

CUERPO A

Elevación eje C

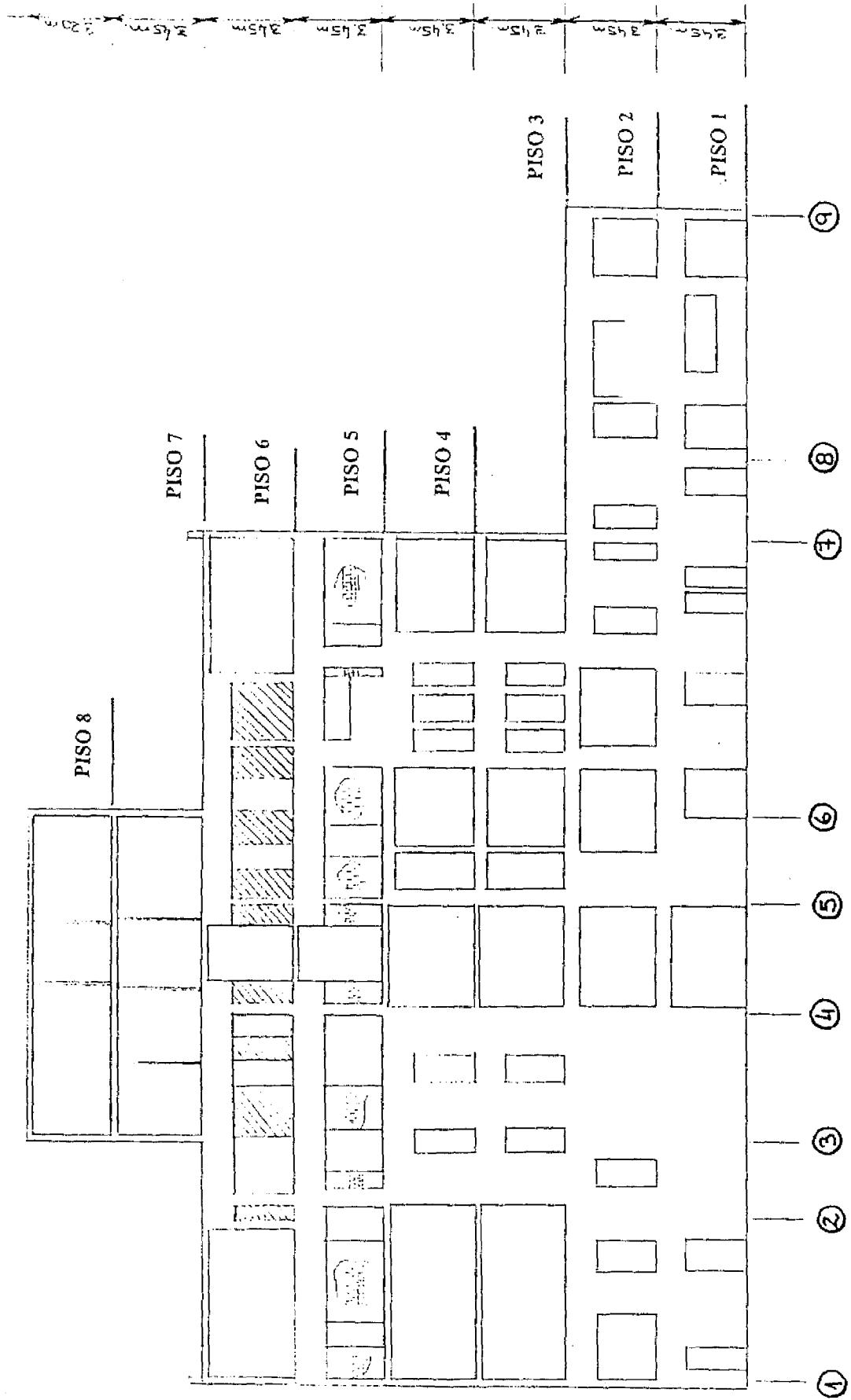

CUERPO A
Elevación eje D

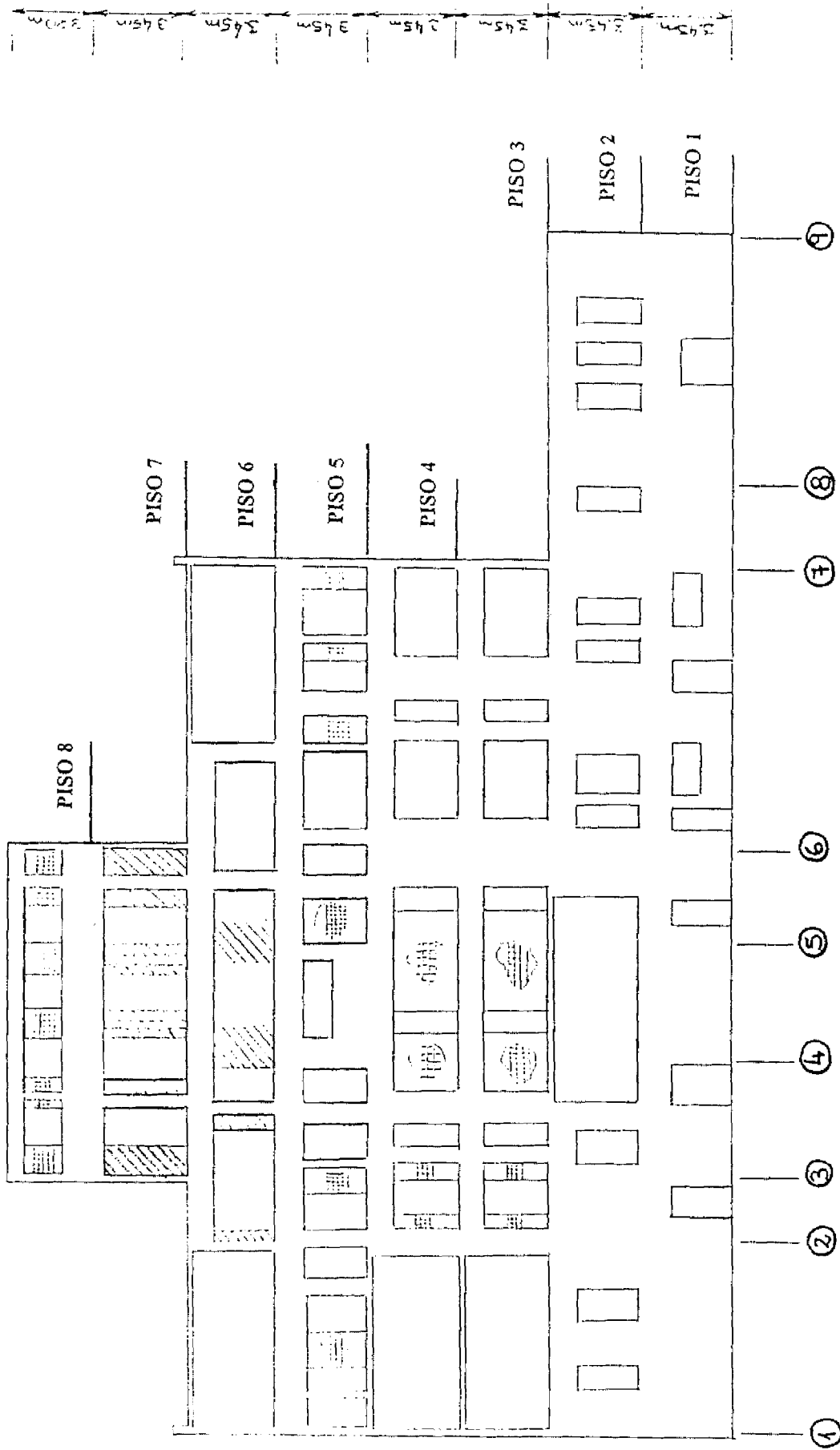

HOSPITAL DE TEMUCO
CUERPO A
Elevación eje E

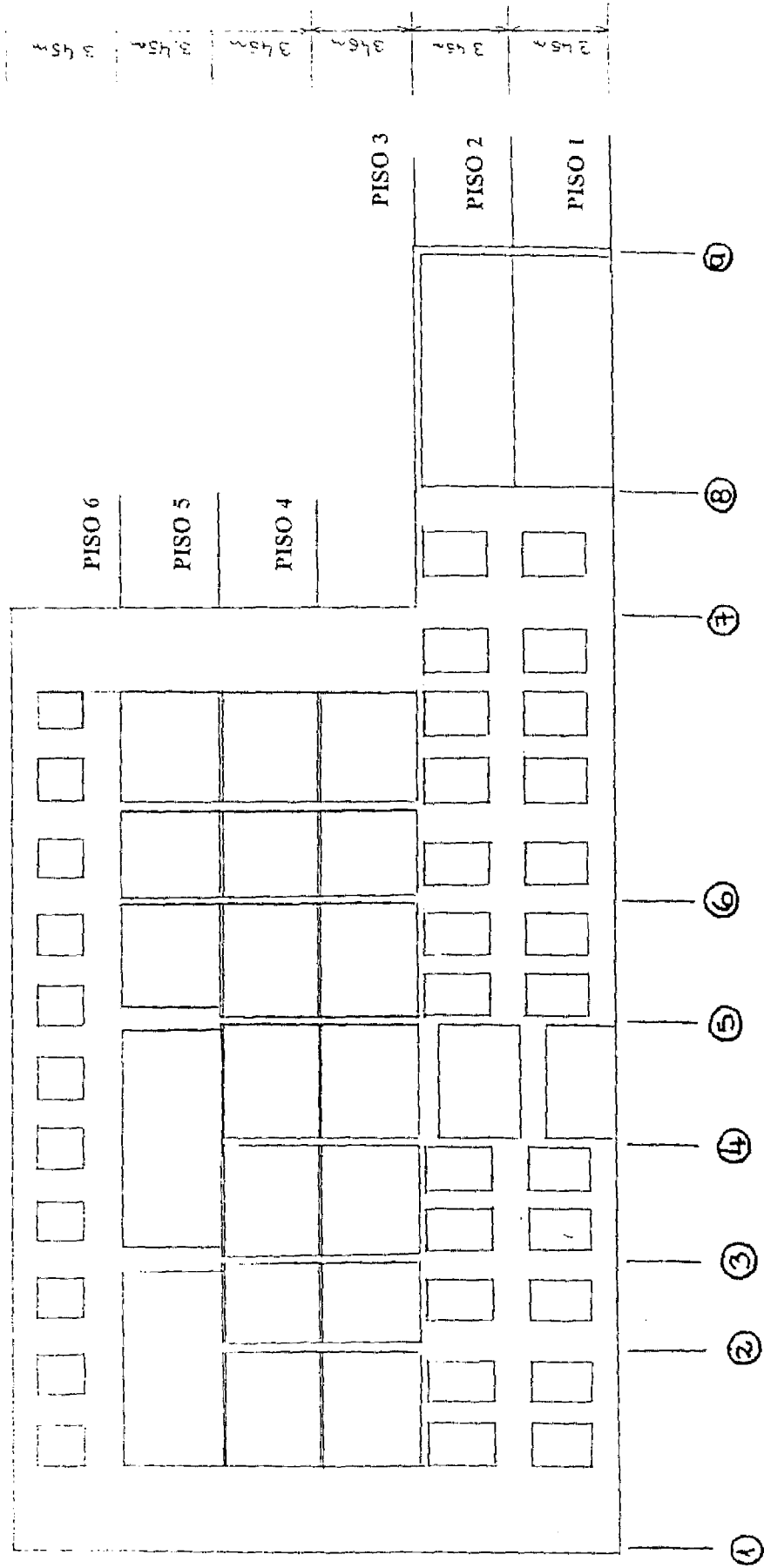

HOSPITAL DE TEMUCO

CUERPO A

Elevación eje 1

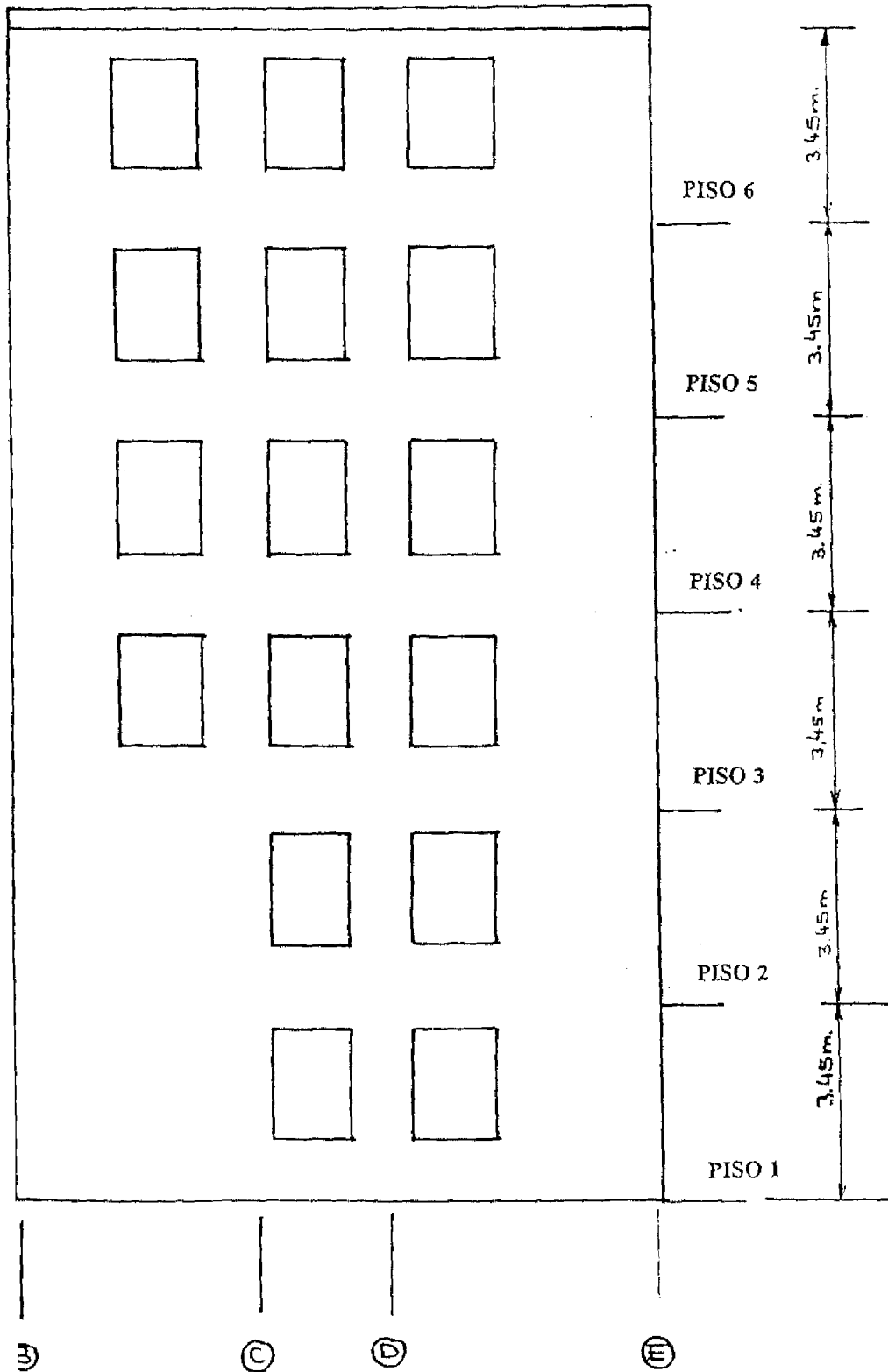

HOSPITAL DE TEMUCO

CUERPO A

Elevación eje 2

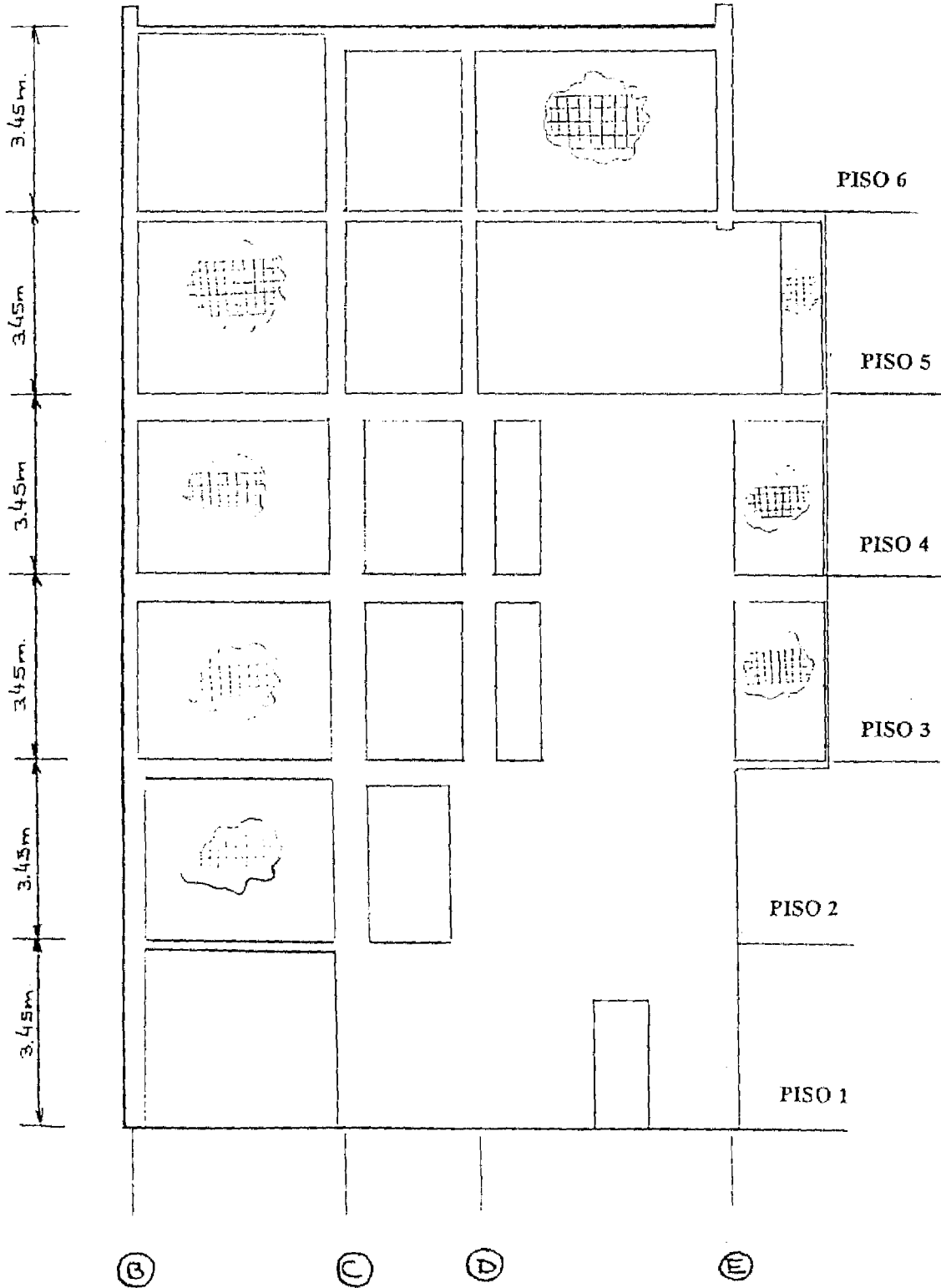

Elevación eje 3

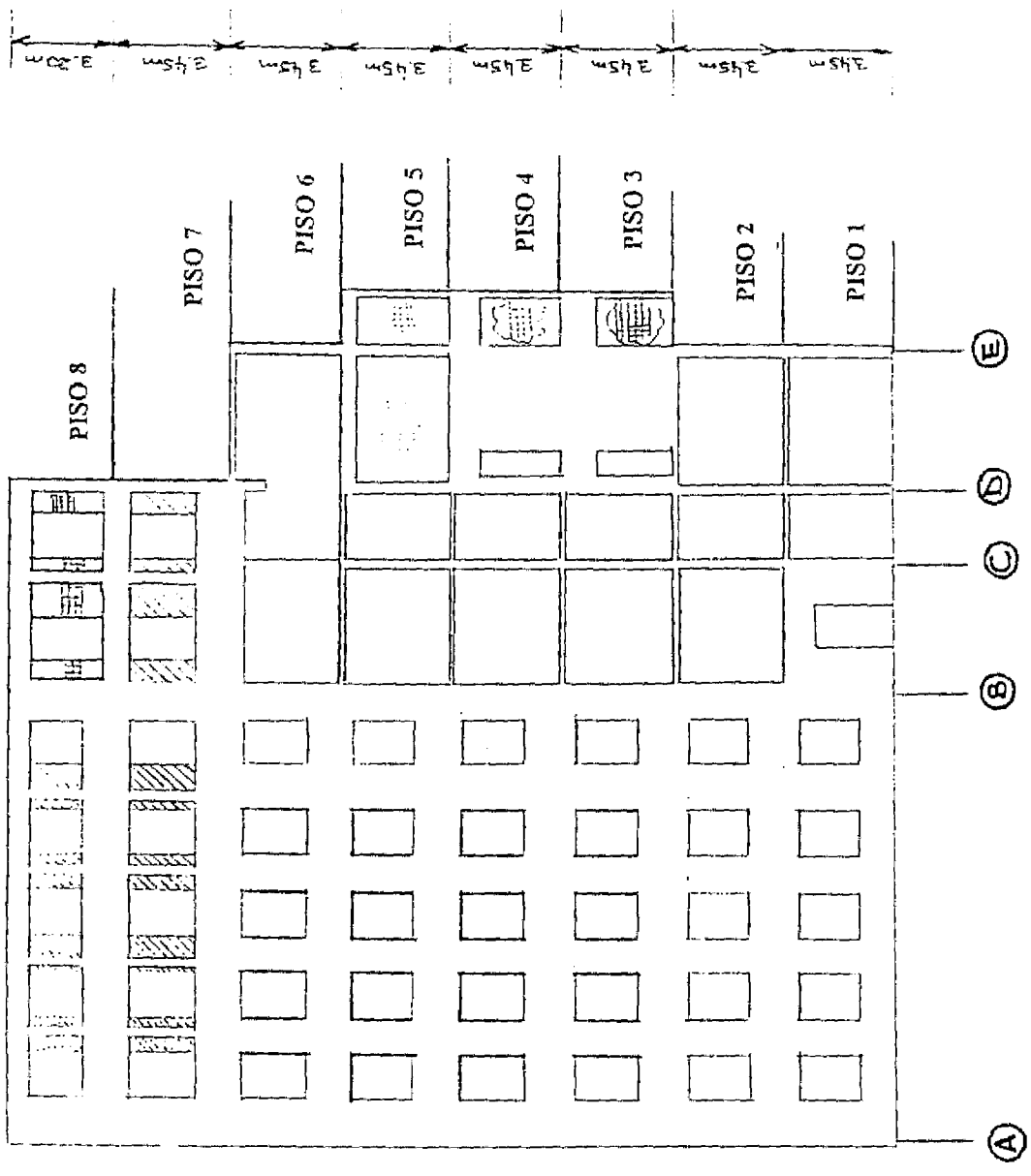

HOSPITAL DE TEMUCO

CUERPO A

Elevación eje 4

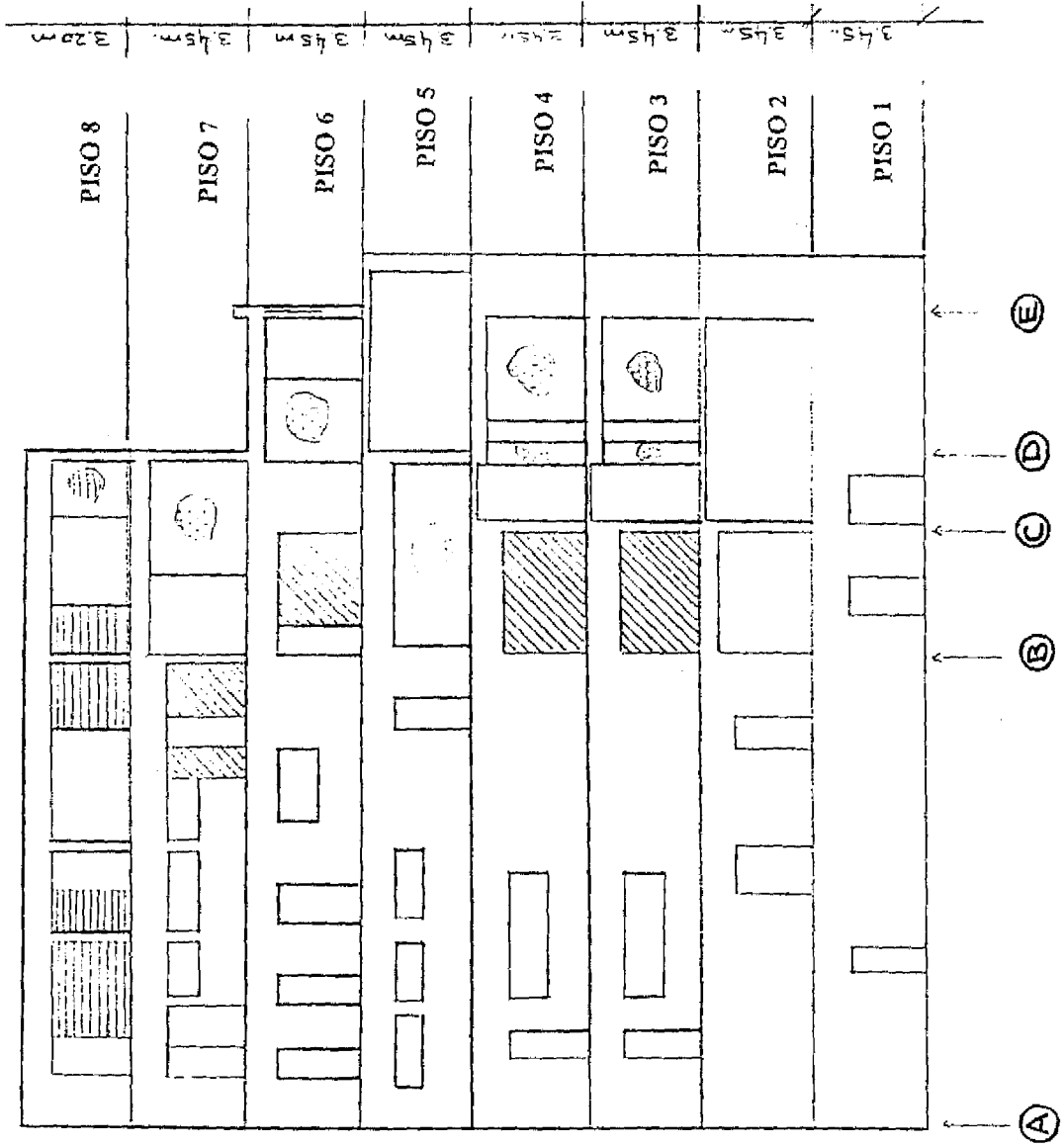

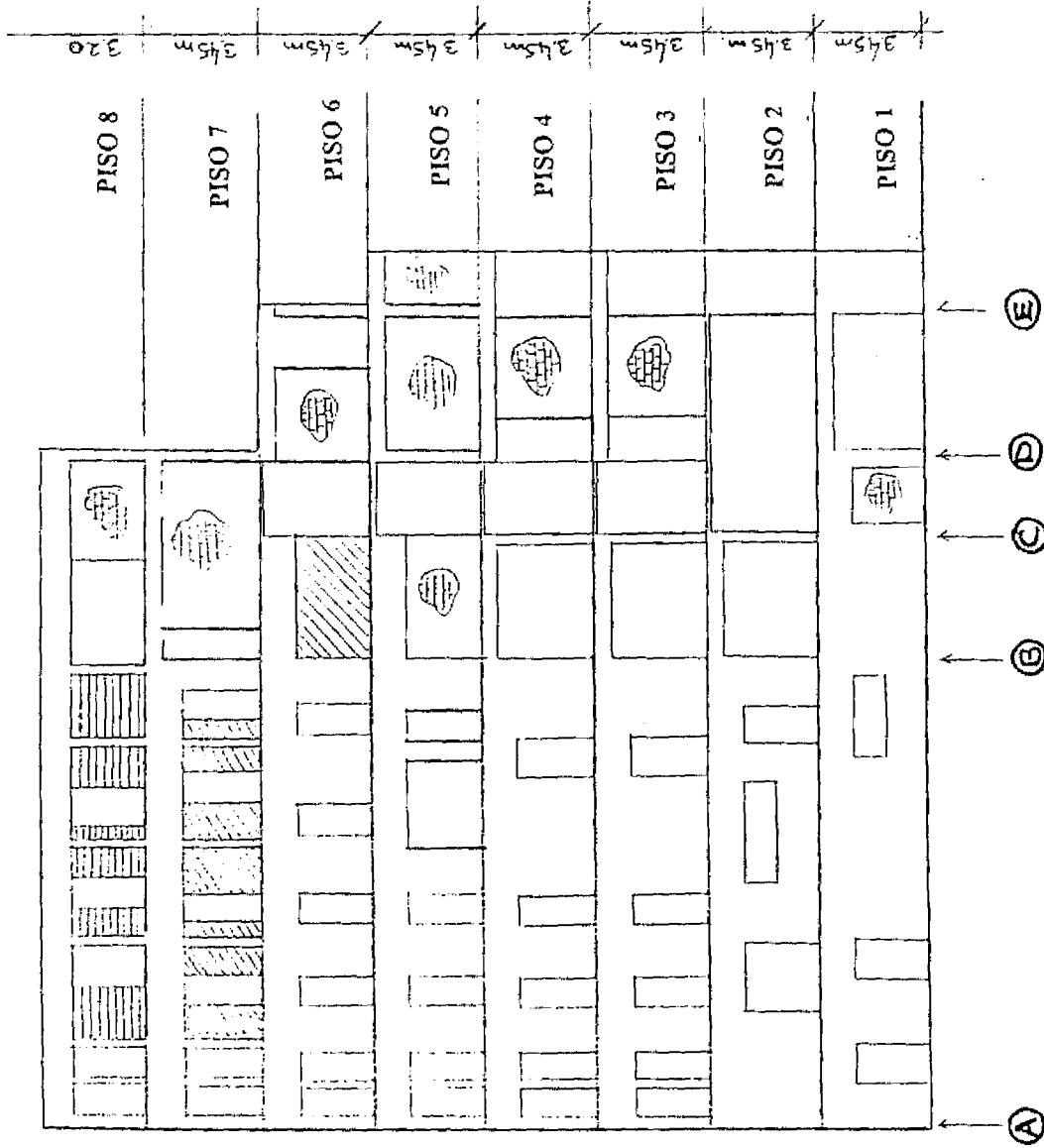

CUERPO A

Elevación eje 6

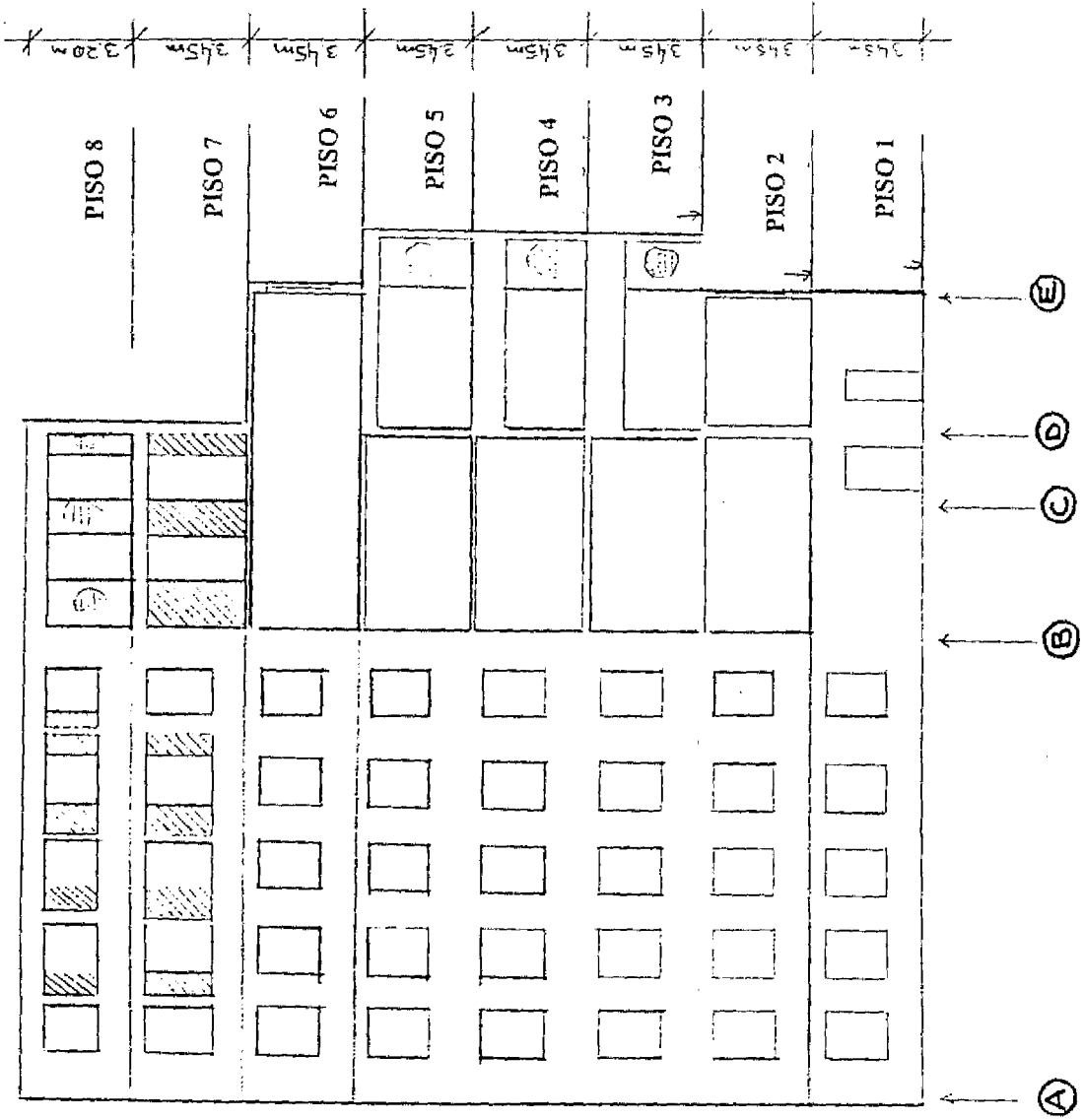

HOSPITAL DE TEMUCO

CUERPO A

Elevación eje 7

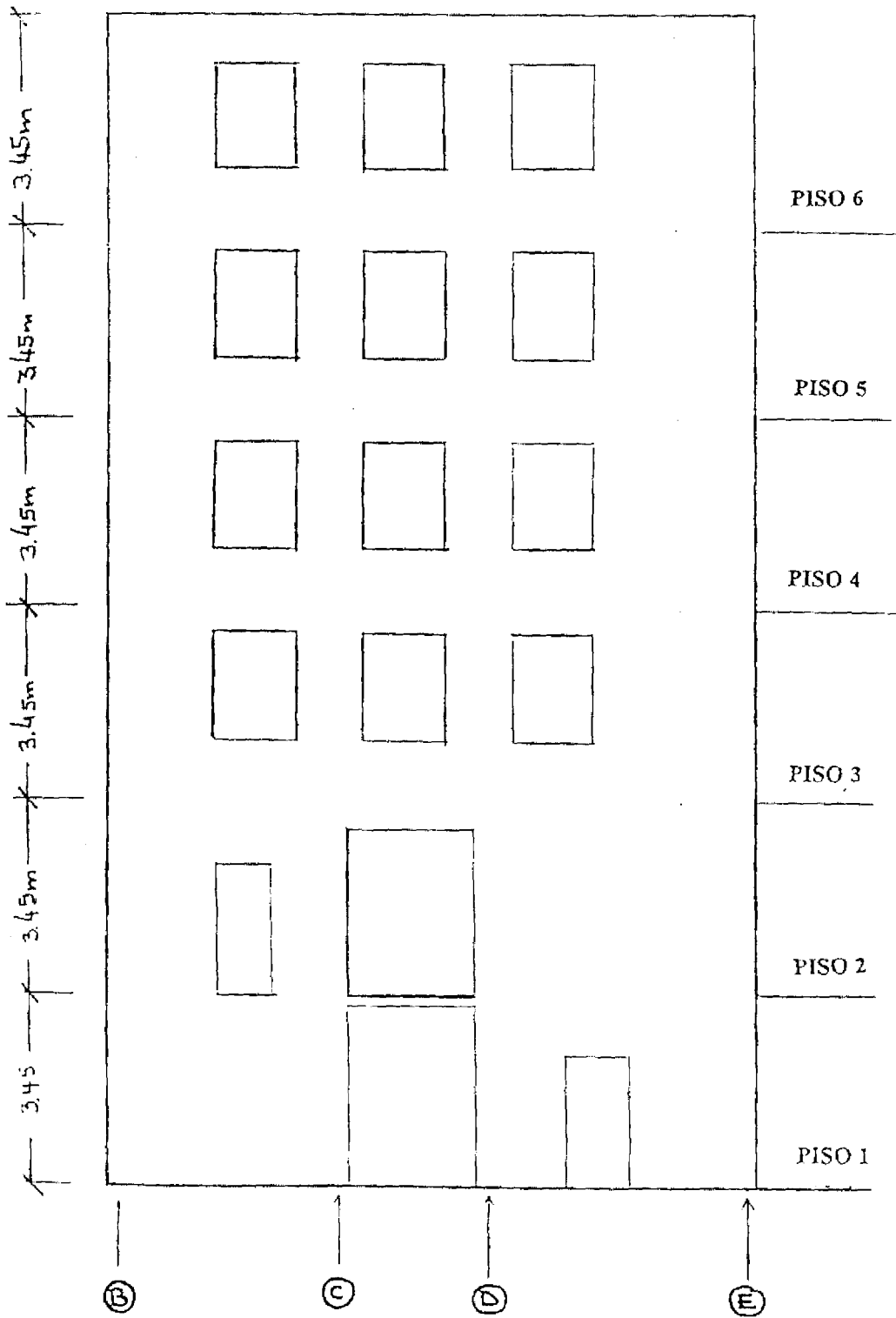

HOSPITAL DE TEMUCO
CUERPO A

Elevación eje 8

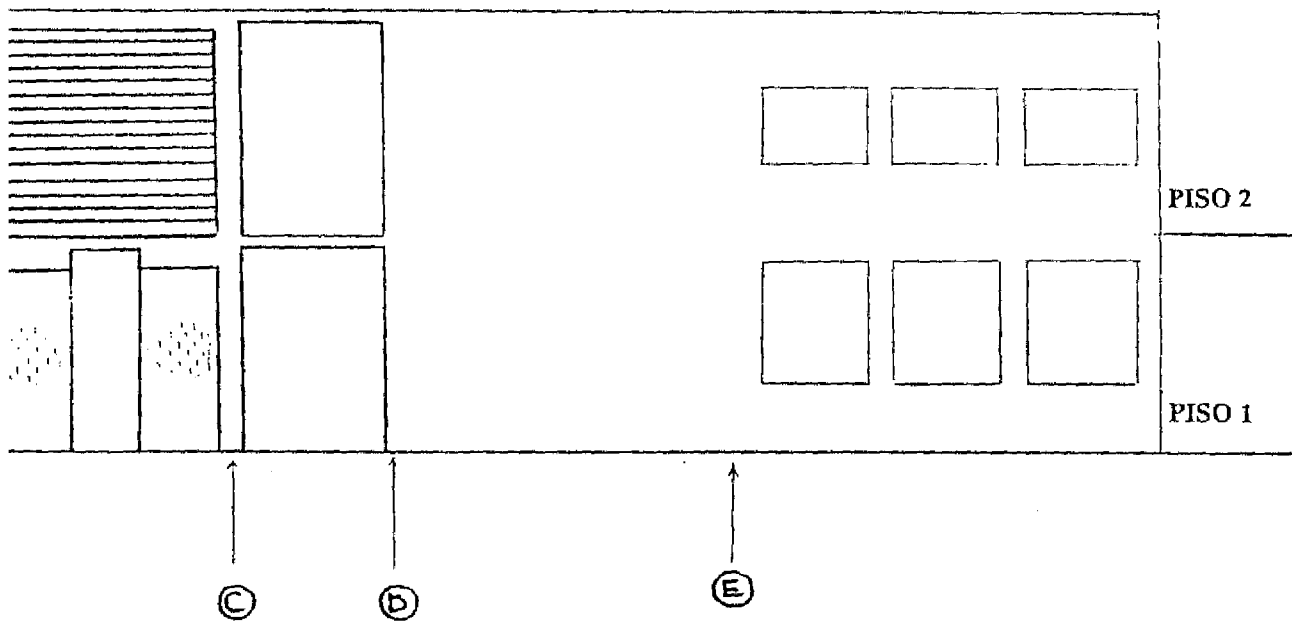

Elevación eje 9

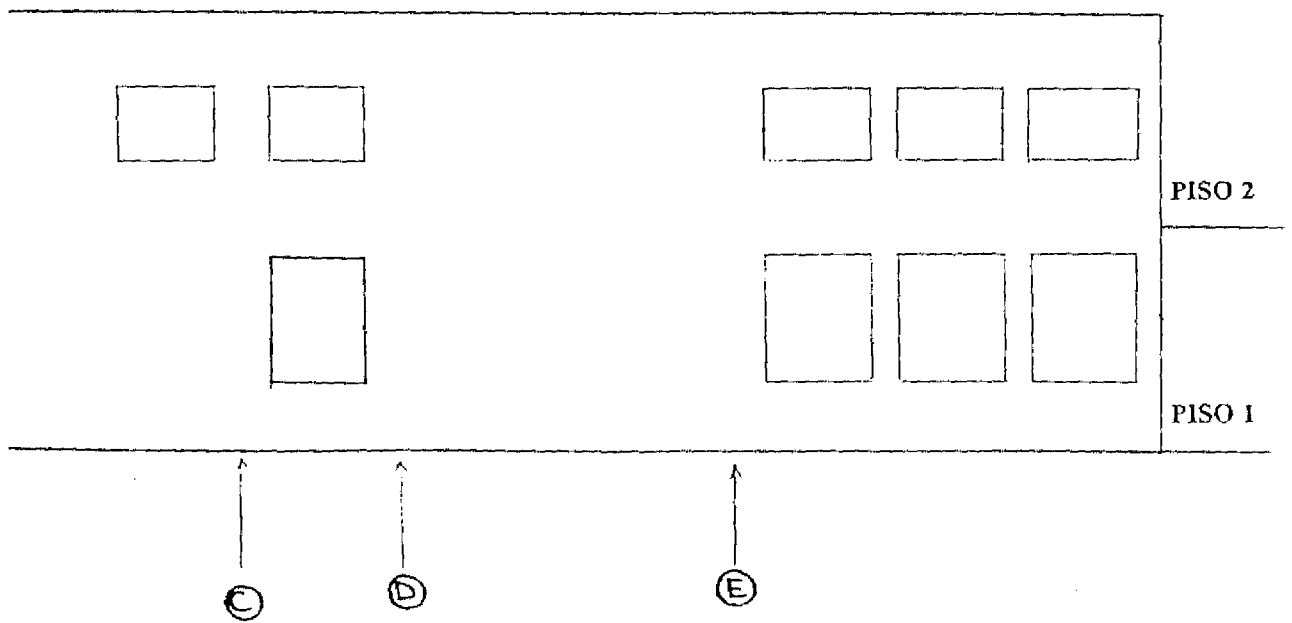

CUERPO B

Elevación eje A

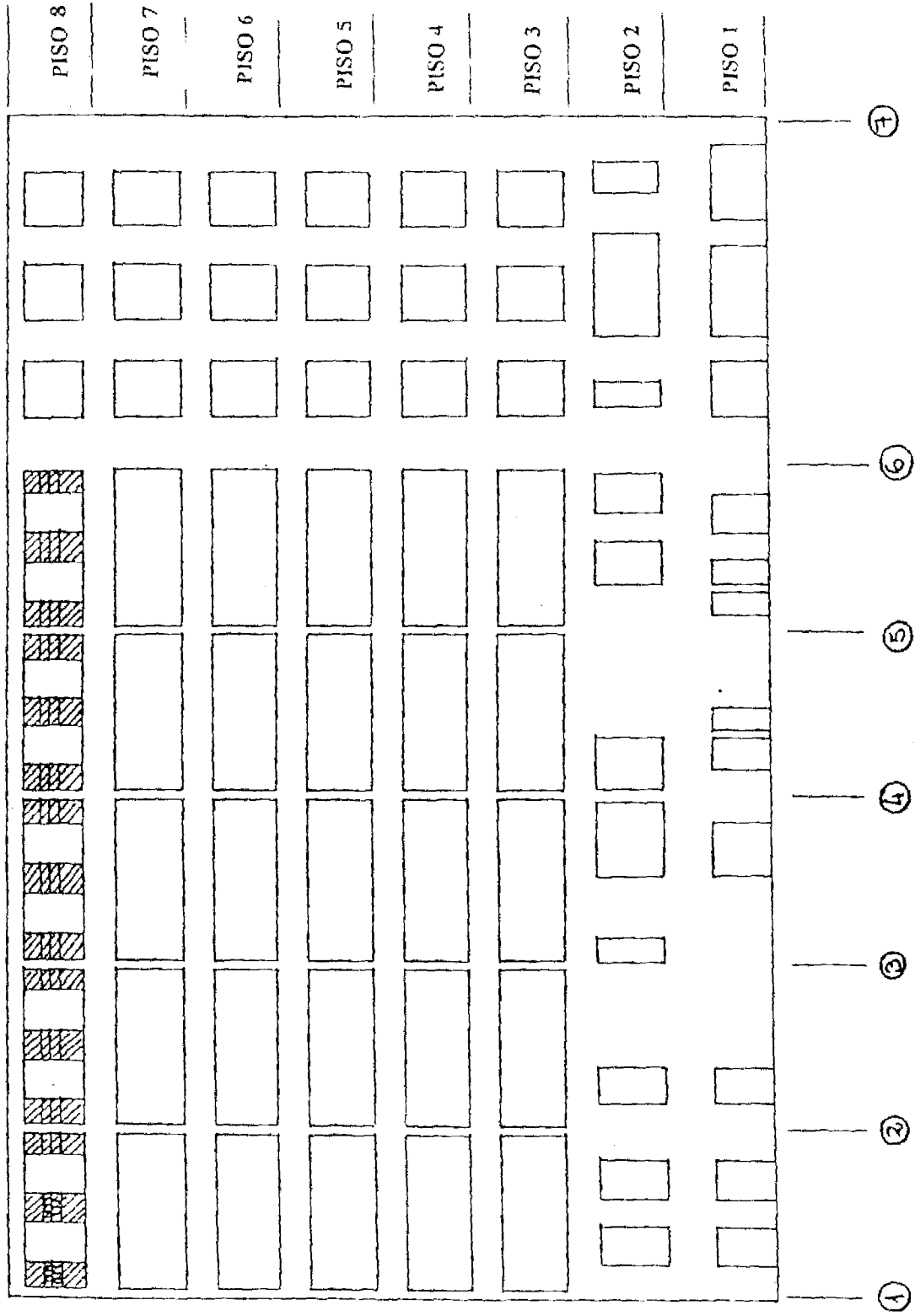

CUERPO B
Elevación eje C

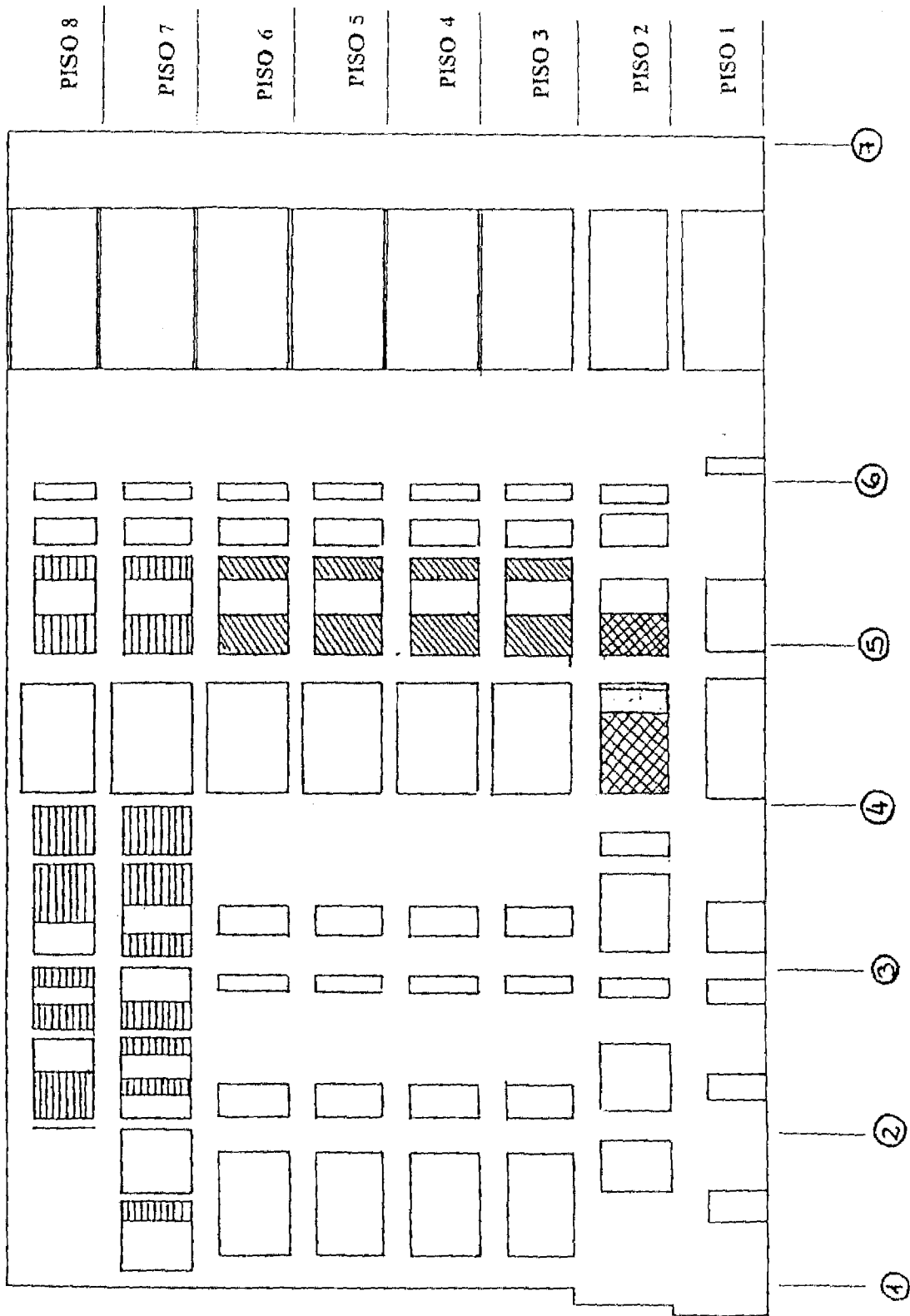

CUERPO B

Elevación eje D

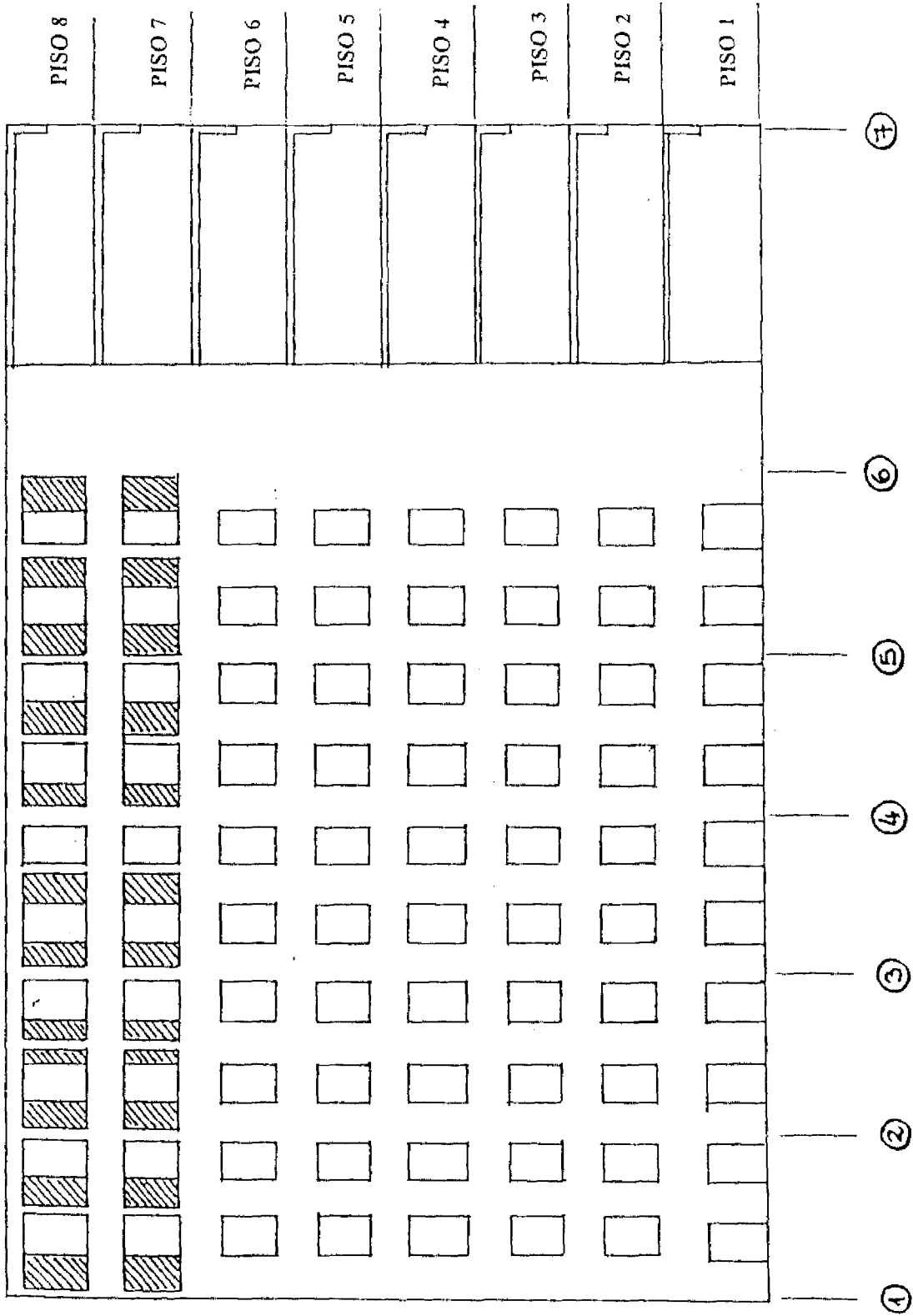

CUERPO B
Elevación eje E

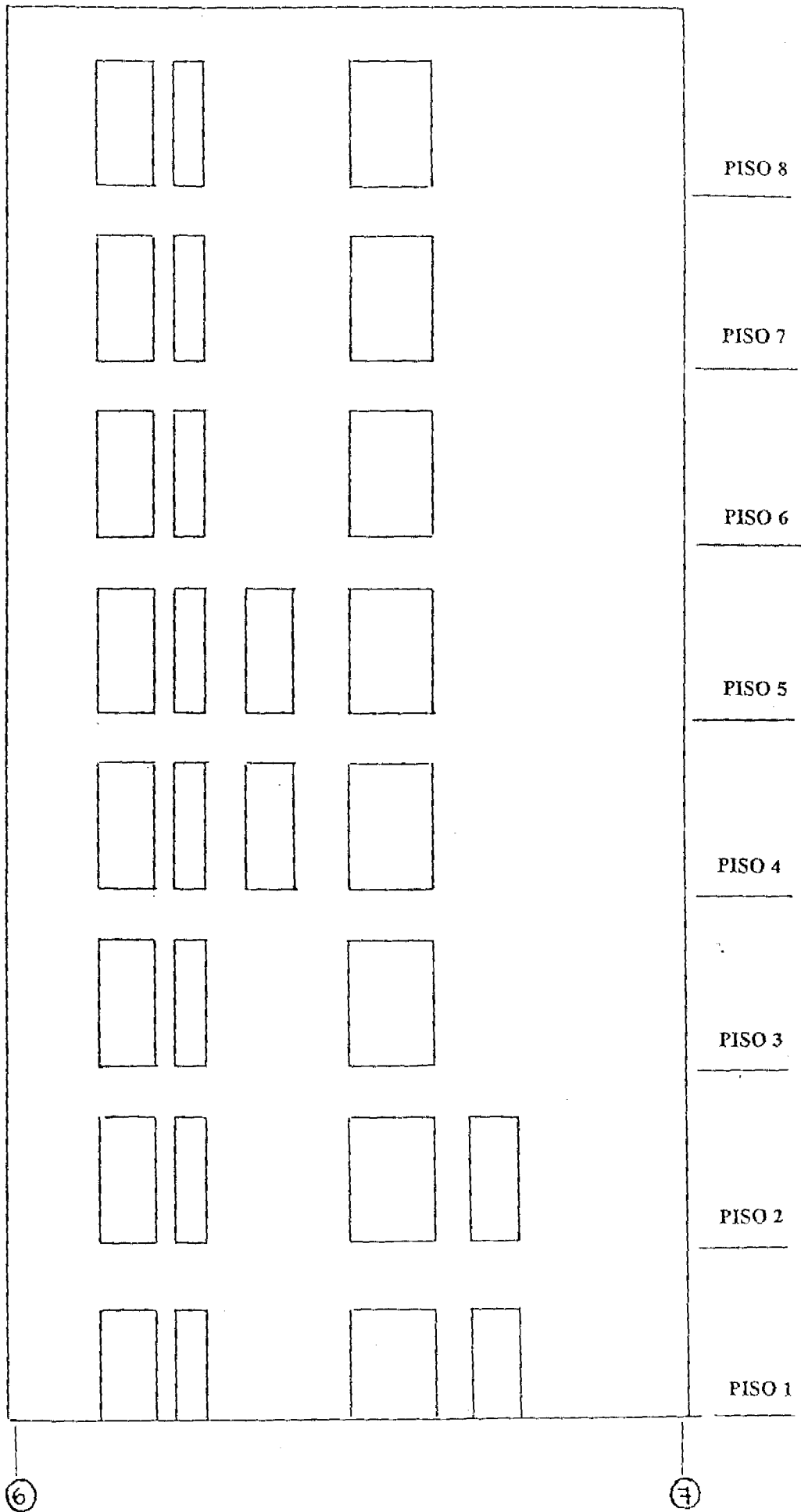

HOSPITAL DE TEMUCO

CUERPO B

Elevación eje 1

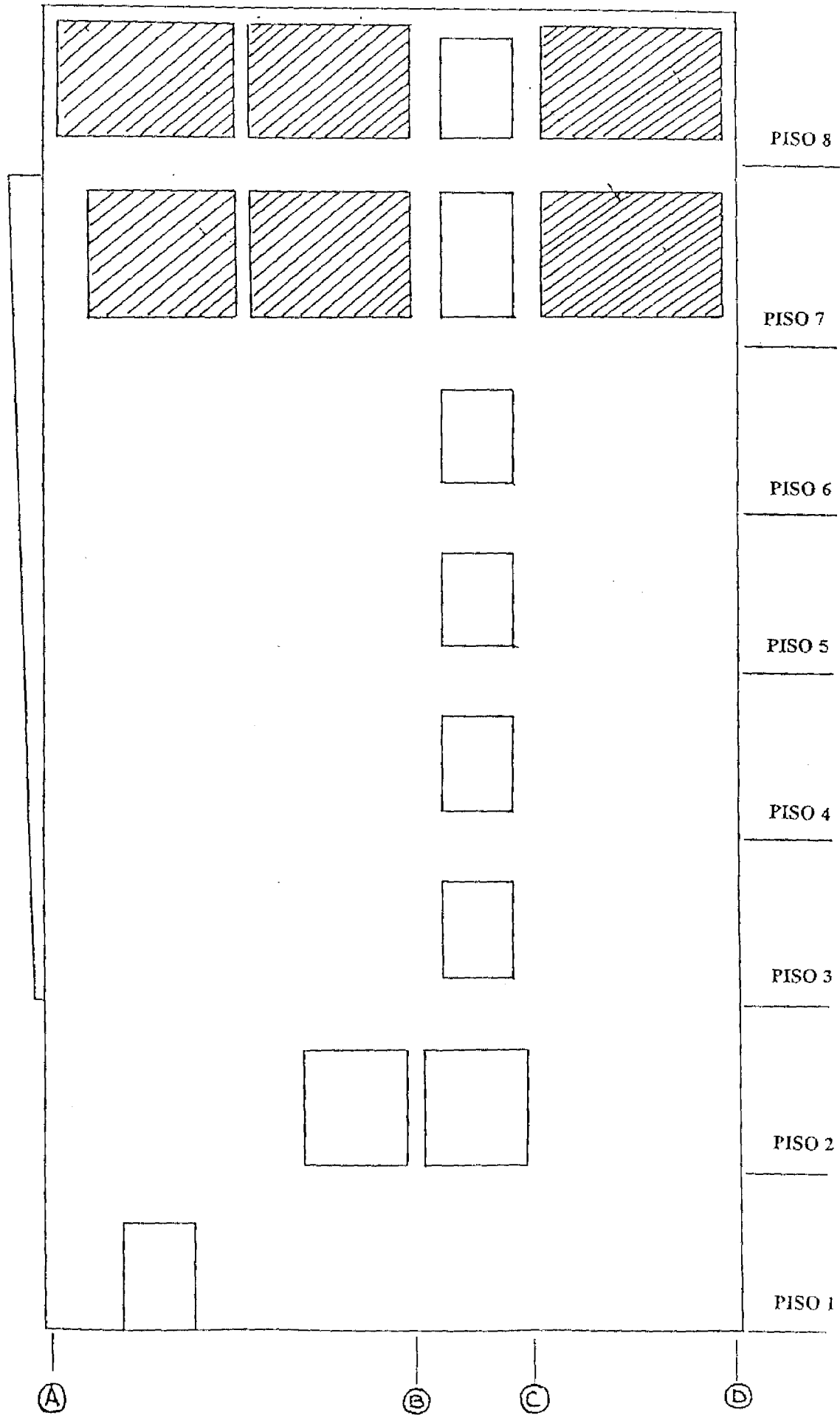

HOSPITAL DE TEMUCO

CUERPO B

Elevación eje 2

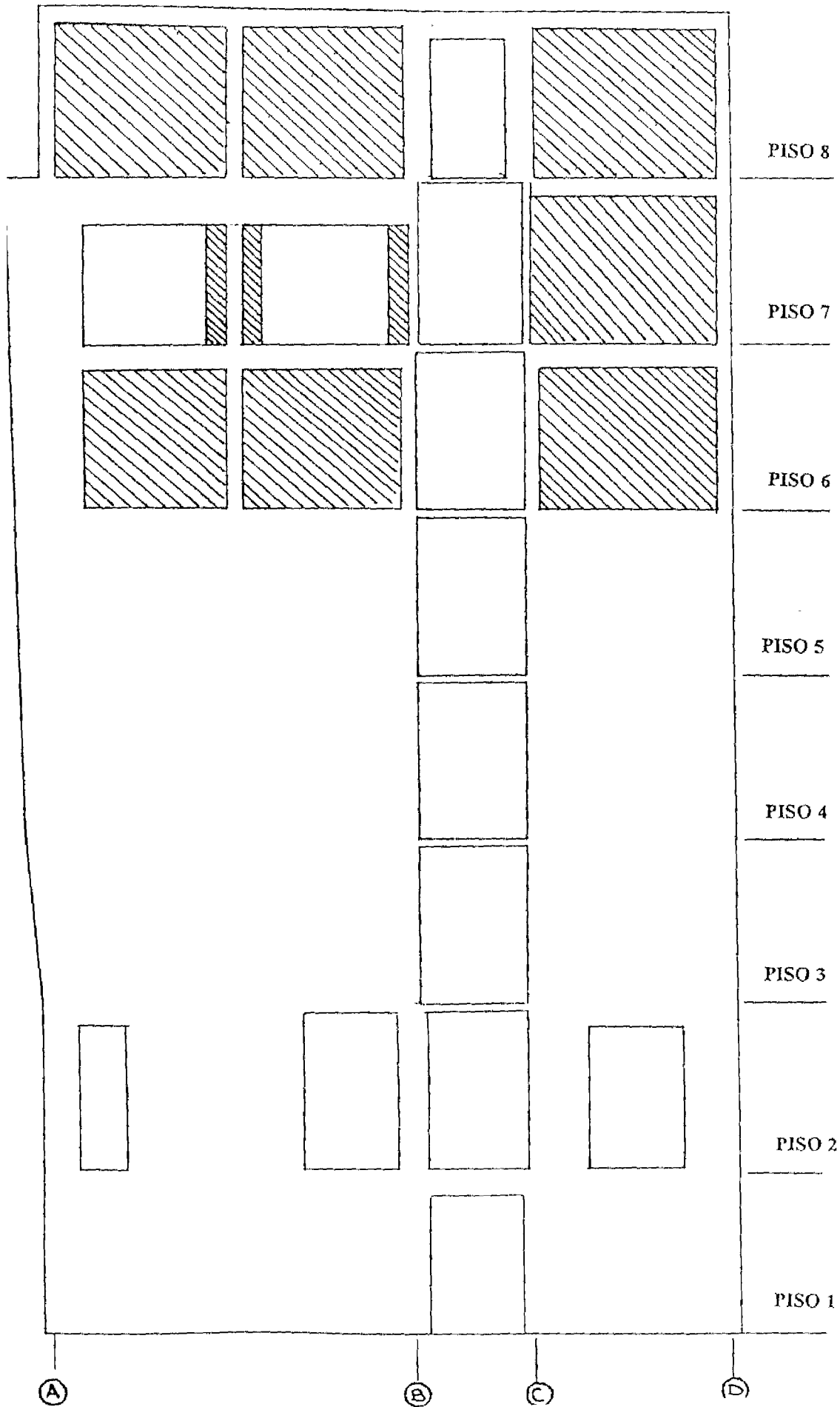

HOSPITAL DE TEMUCO

CUERPO B

Elevación eje 3

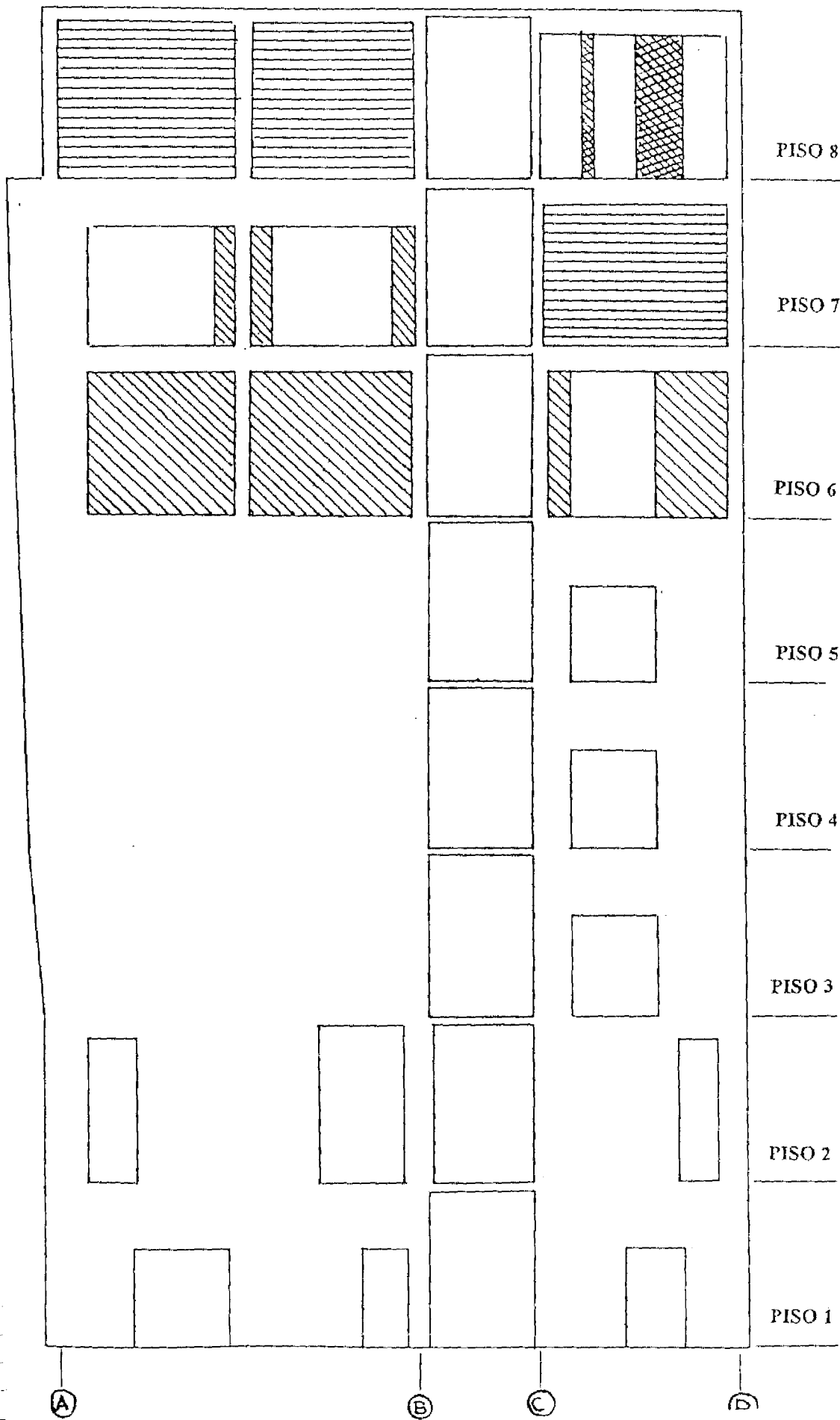

HOSPITAL DE TEMUCO

CUERPO B

Elevación eje 6

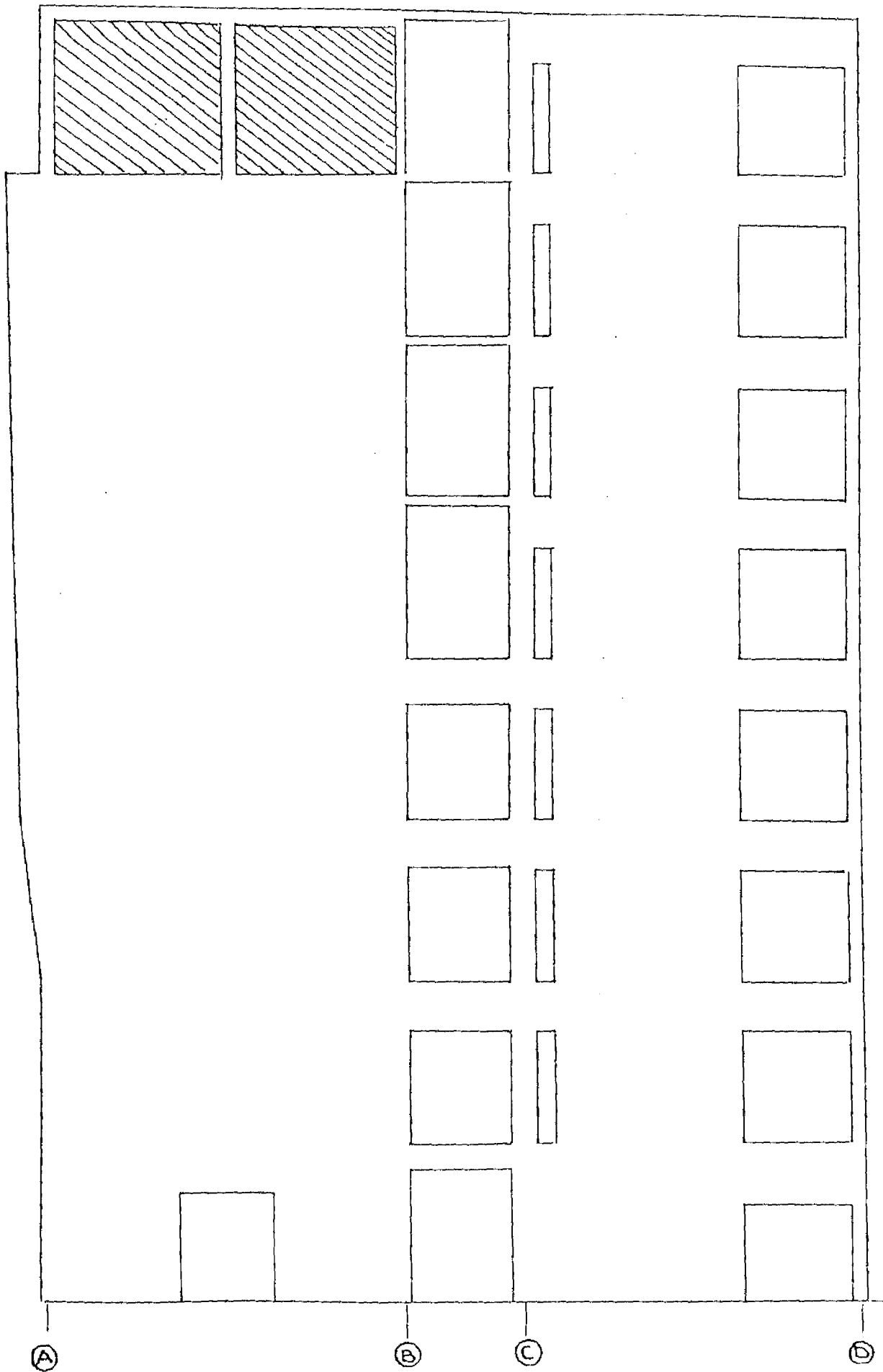

Elevación eje 7

